

ENGINEER OF RECORD

NO.	REVISIONS	BY	APP.	DATE

CALIFORNIA

TRUCKEE TAHOE AIRPORT
EXECUTIVE HANGAR DEVELOPMENT
OVERALL LAYOUT PLAN - PHASE 1

DATE:	JAN 13 2017
DRAWN:	MAZ
CHECKED:	RWB
PROJECT No.:	
PREPARE Ultimate Development:	
SCALE:	1"=50'
SHEET No.:	XX

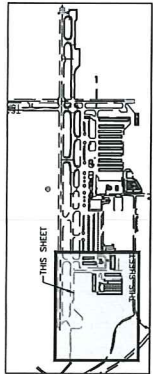
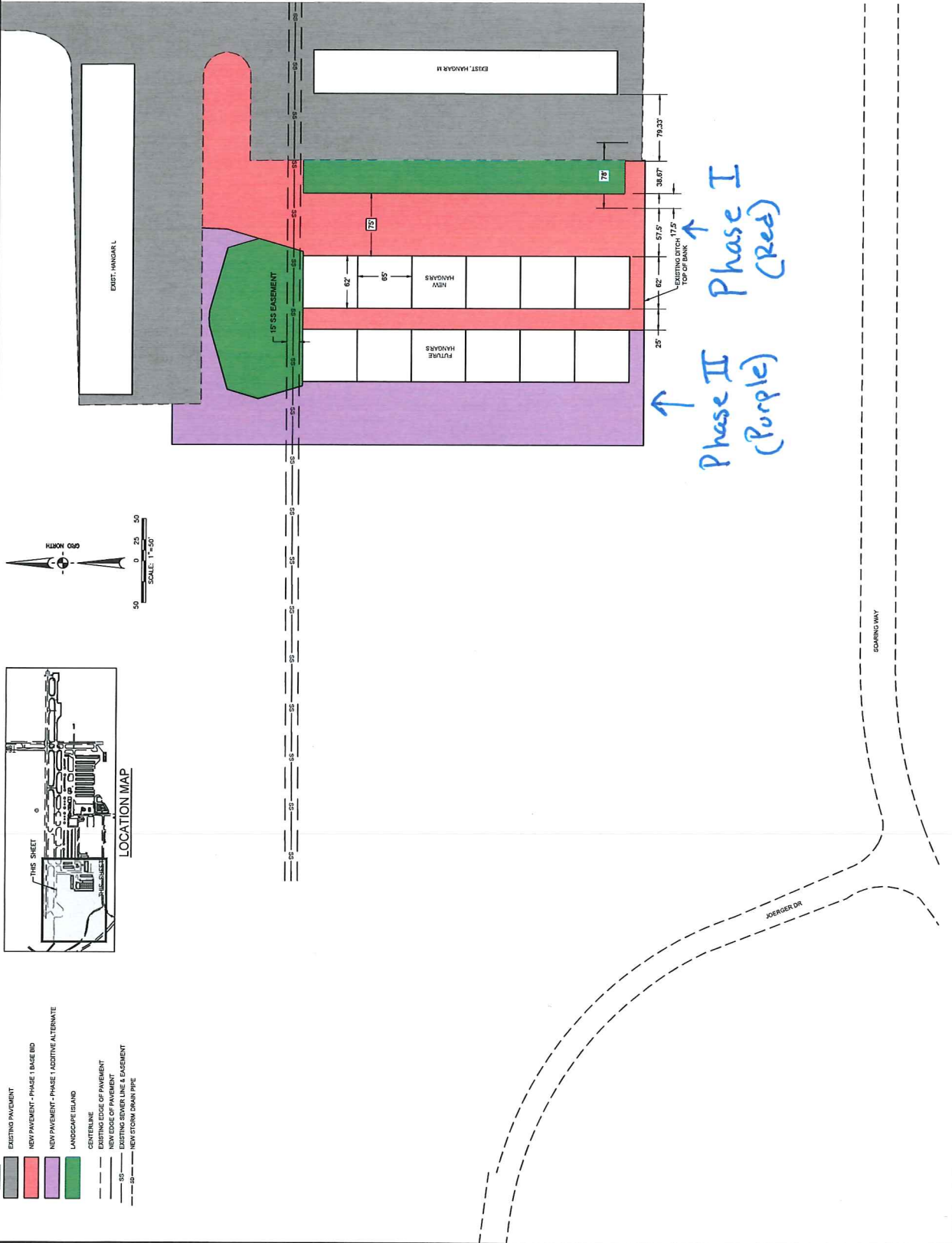

LOCATION MAP

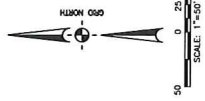

- LEGEND**
- EXISTING PAVEMENT
 - NEW PAVEMENT - PHASE I BASE BID
 - NEW PAVEMENT - PHASE I ADDITIVE ALTERNATE
 - LANDSCAPE ISLAND
 - CENTERLINE
 - EXISTING EDGE OF PAVEMENT
 - NEW EDGE OF PAVEMENT
 - EXISTING SEWER LINE & EASEMENT
 - NEW STORM DRAIN PIPE

DATE DATE DATE
 DRAWN MSB
 CHECKED RWB
 PROJECT No. 4026-1
 FILE 4026-1.00.Dwg
 SCALE 1"=300'
 SHEET No. 3 of XX

TRUCKEE TAHOE AIRPORT
 EXECUTIVE HANGAR DEVELOPMENT - PHASE 1
 CALIFORNIA
 COORDINATE LAYOUT PLAN

NO.	REVISIONS	BY	DATE

ENGINEER OF RECORD
DRAFT

Reinard W. Brandley
 CONSULTING AIRPORT ENGINEER
 6122 King Road, Suite 201 - Lookout, California 95959 - (916) 652-4725

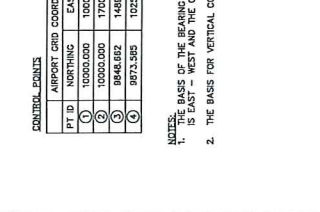
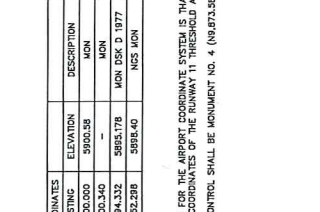
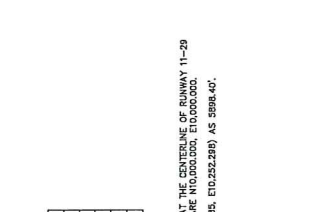
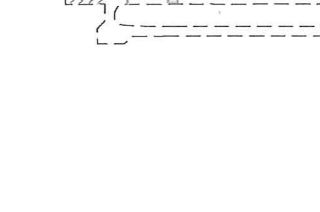
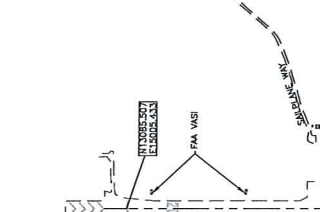
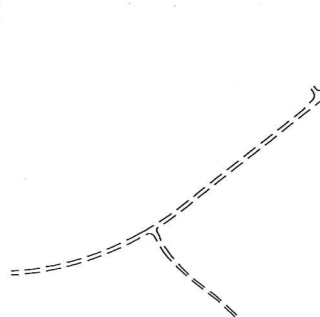
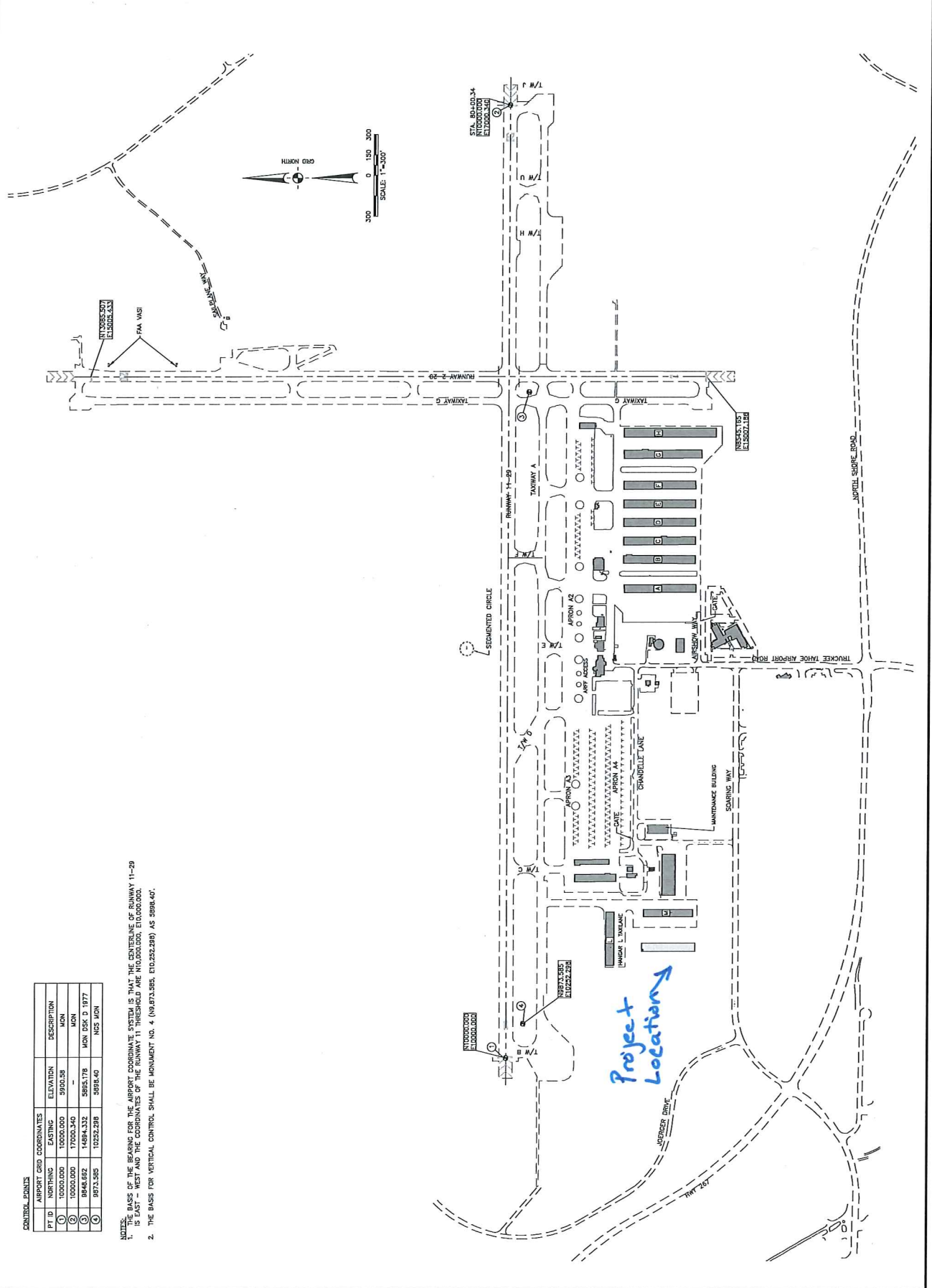

CONTROL POINTS

PT ID	NORTHING	EASTING	ELEVATION	DESCRIPTION
①	10000.000	17000.000	5900.55	MON
②	10000.000	17000.000	-	MON
③	9648.892	14894.332	5885.178	MON DSK D 1977
④	9973.505	10252.288	5898.40	NCS MON

- NOTES:
 1. THE BASIS FOR THE AIRPORT COORDINATE SYSTEM IS THAT THE CENTERLINE OF RUNWAY 11-29 IS EAST - WEST AND THE COORDINATES OF THE RUNWAY 11 THRESHOLD ARE N10000.000, E10000.000.
 2. THE BASIS FOR VERTICAL CONTROL SHALL BE MONUMENT NO. 4 (N6.873.385, E10.252.299) AS 8998.40.

Project Location

DRAFT

NO.	REVISIONS	BY	DATE

TRUCKEE TAHOE AIRPORT
 EXECUTIVE HANGAR DEVELOPMENT - PHASE 1
 CALIFORNIA
 GRADING PLAN
 SITE DEVELOPMENT

DATE	DATE
DRAWN BY	MSB
CHECKED BY	MSB
PROJECT NO.	401283
FILE NO.	2.02 Grading Plan
SCALE	1"=20'
SHEET NO.	5 of XX

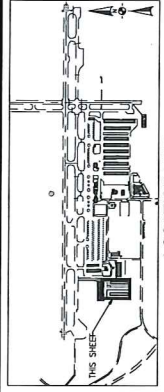

- LEGEND**
- APPROX. AIR PROJECTIONS
 - FINISHED GRADE ELEVATION
 - EXISTING AC PAVEMENT
 - NEW PCC SLAB - SEE NOTE 1
 - NEW AC SLAB
 - EXISTING EDGE OF PAVEMENT
 - NEW EDGE OF PAVEMENT
 - EXISTING SEWER LINE & CASSEMENT
 - NEW STORMDRAIN
 - CRAKEBREAK LINE
 - EXISTING CONTOUR
 - NEW CONTOUR

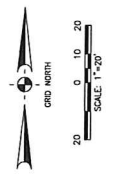

NOTES:
 1. CONCRETE SHALL BE PLACED IN ALL CORNERS AND PLACEMENT OF AGGREGATE BASE COURSE FOR NEW PCC SHALL BE PLACED BY PCC SLAB (BY OTHERS).
 NEW PCC (BY OTHERS) COMING & NEW AC (THIS CONTRACT) SEE NOTE 1, NEW AC (THIS CONTRACT)

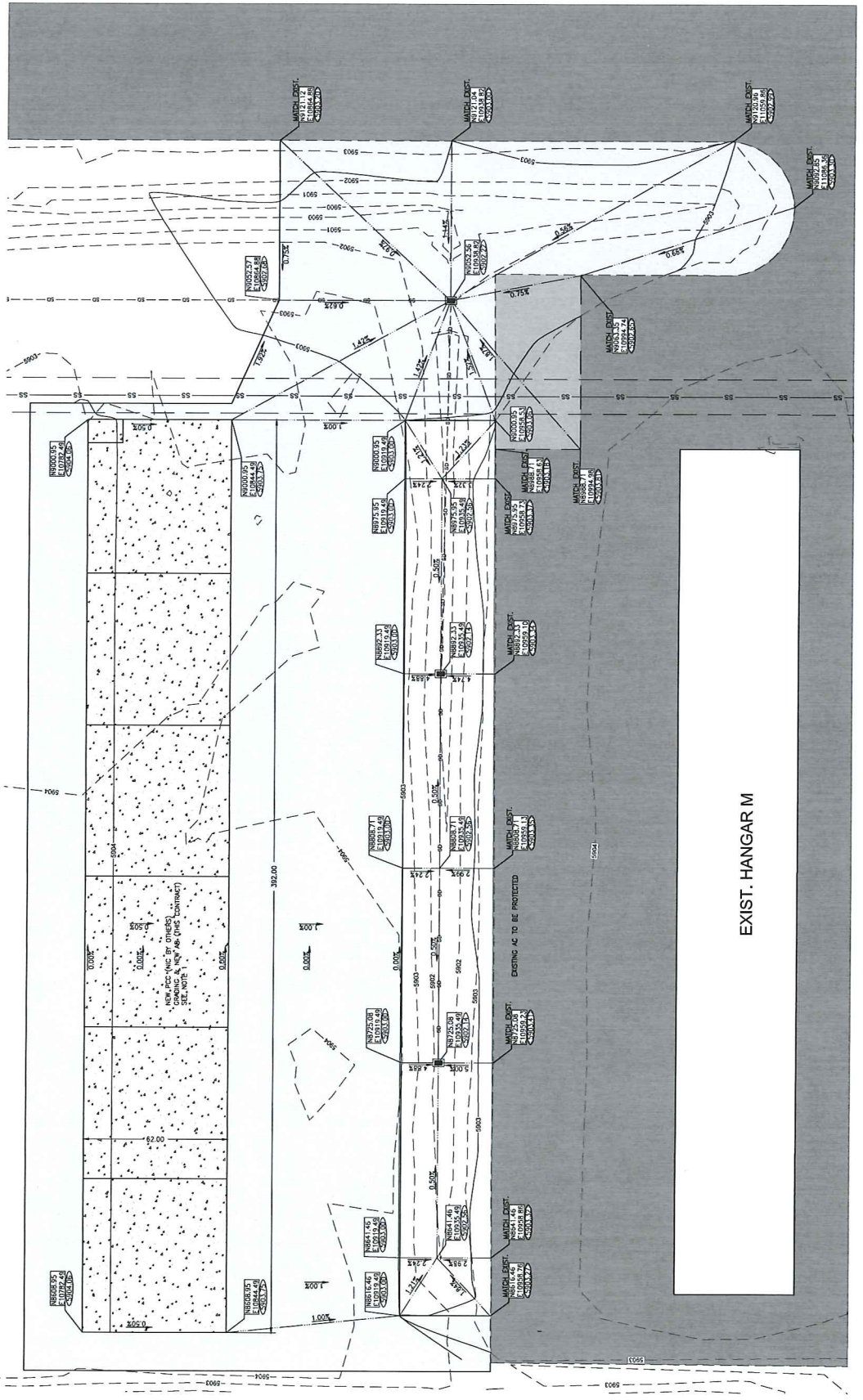



DATE	DATE
TRUCKEE	

REVISIONS	BY	APR	DATE
1/6			

ENGINEER OF RECORD
Reinard W. Brandley

CONSULTING AIRPORT ENGINEER
6123 King Road, Suite 201 - North, California 95950 - (916) 922-4725

DATE	DATE
TRUCKEE	

REVISIONS	BY	APR	DATE
1/6			

ENGINEER OF RECORD
Reinard W. Brandley

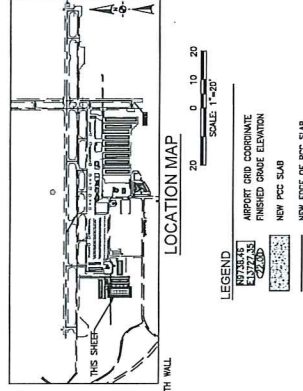

GENERAL NOTES:
FOUNDATIONS SHOWN ARE TYPICAL REPRESENTATION OF SPACING. CONTRACTOR SHALL VERIFY ALL FOUNDATION REQUIREMENTS AND SHALL BE RESPONSIBLE FOR THE DESIGN AND STRUCTURAL REQUIREMENTS. FINAL DESIGN AND STRUCTURAL REQUIREMENTS ARE THE RESPONSIBILITY OF THE CONTRACTOR.

