

TRUCKEE TAHOE AIRPORT TRUCKEE, CALIFORNIA		No. _____ REVISIONS BY _____ APR _____ DATE _____ ENGINEER OF RECORD	
EXECUTIVE HANGAR DEVELOPMENT		REINARD W. BRANDLEY CONSULTING AIRPORT ENGINEER	
OVERALL LAYOUT PLAN - PHASE 1		6125 King Road, Suite 201 • Loomis, California 95650 • (916) 652-4725	

DATE: JAN 3, 2017
 DRAWN: MSB
 CHECKED: RWB
 PROJECT NO.: 17-001
 SHEET NO.: XX

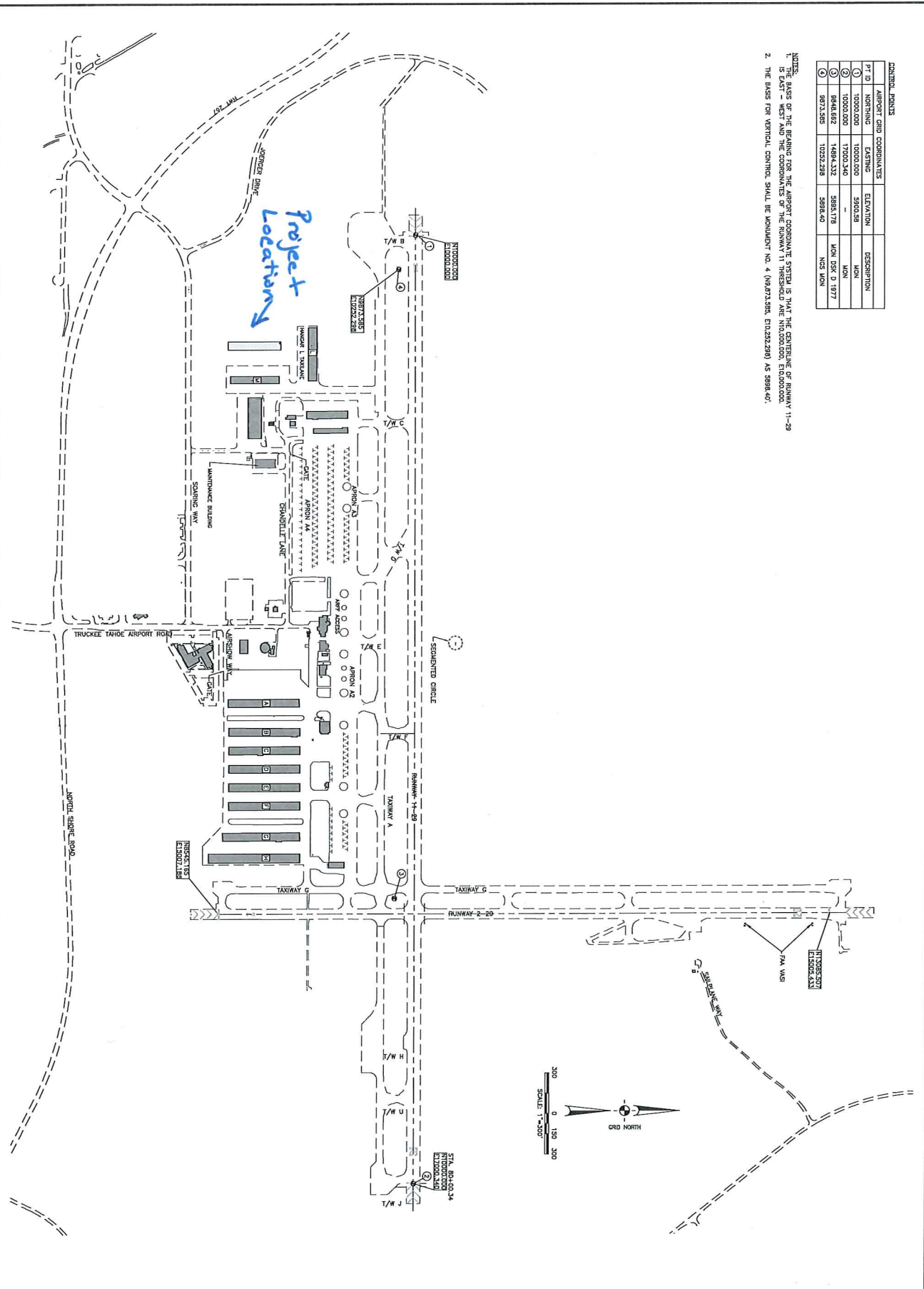

CONTROL POINTS				
PT ID	NORTHING	EASTING	ELEVATION	DESCRIPTION
1	10000.000	10000.000	3900.38	MON
2	10000.000	17000.340	-	MON
3	9848.682	14894.332	5898.178	MON DISK D 1977
4	9873.385	10252.288	5898.40	NCS MON

- NOTES:
1. THE BASIS OF THE BEARING FOR THE AIRPORT COORDINATE SYSTEM IS THAT THE CENTERLINE OF RUNWAY 11-29 IS EAST - WEST AND THE COMPONENTS OF THE RUNWAY 11 THRESHOLD ARE N10300.000, E10300.000.
 2. THE BASIS FOR VERTICAL CONTROL SHALL BE MONUMENT NO. 4 (N8472358, E10252288) AS 5898.40.

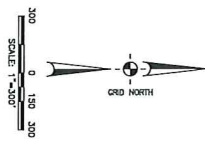

<p>TRUCKEE TAHOE AIRPORT EXECUTIVE HANGAR DEVELOPMENT - PHASE 1 HANGAR BUILDINGS COORDINATE LAYOUT PLAN</p>	No. _____ REVISIONS _____ BY APR _____ DATE _____	ENGINEER OF RECORD <p style="color: red; text-align: center;">DRAFT</p>	<p style="text-align: right;">Reinard W. Brandley CONSULTING AIRPORT ENGINEER</p> <p style="font-size: small; text-align: right;">6125 King Road, Suite 201 • Loomis, California 95650 • (916) 652-4725</p>
DATE _____ DATE _____ DRAWN _____ CHECKED _____ PROJECT NO. 402-01 SCALE 1"=300' SHEET NO. 3 of XX			

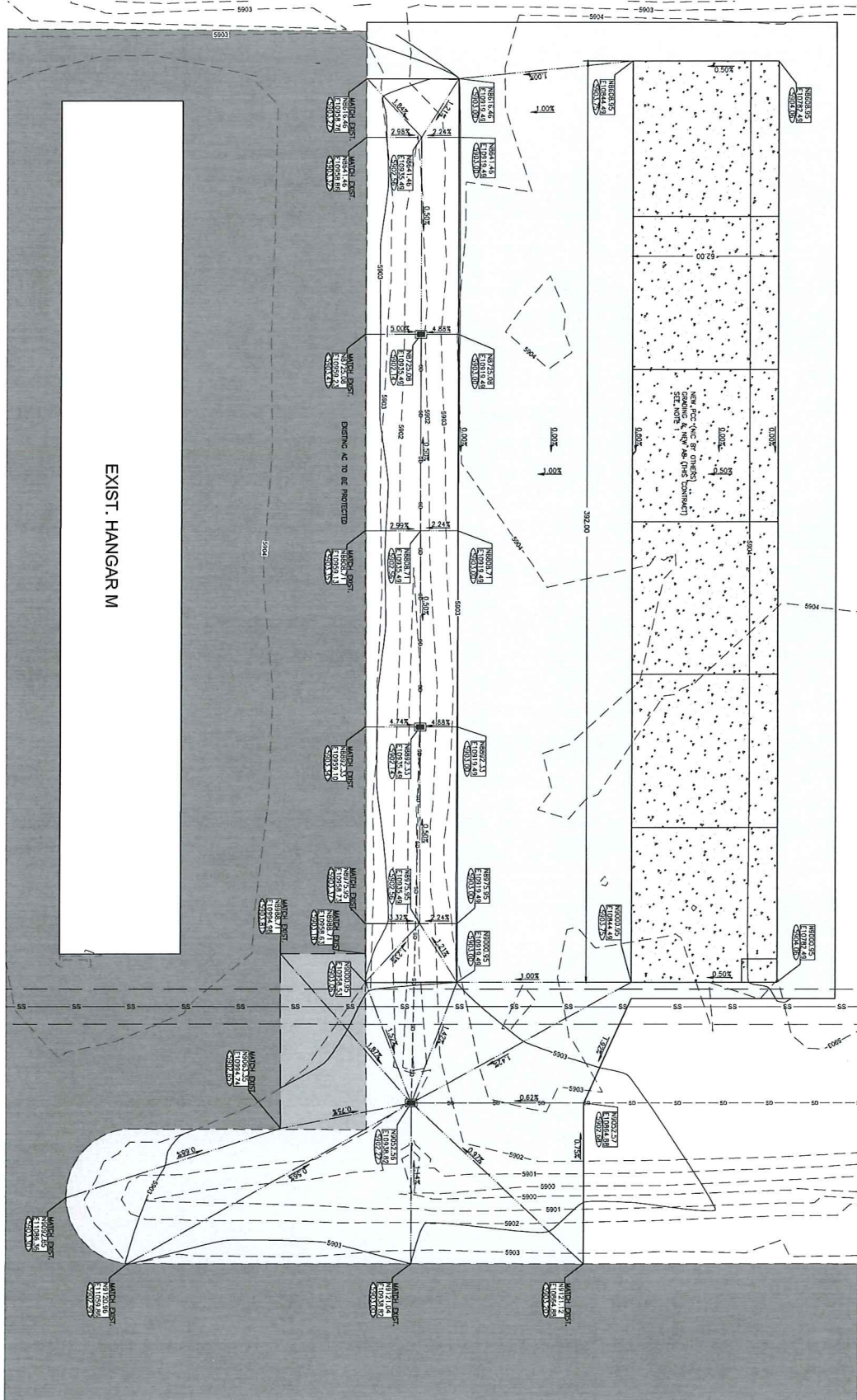

NOTES:
 1. CONTRACTOR SHALL PERFORM ALL GRADING AND PLACEMENT OF APPROPRIATE BASE COURSE FOR NEW PCC SLAB. PLACEMENT OF PCC SLAB MC (OR OTHERS)

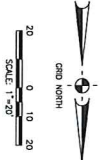

LEGEND

	AIRPORT GRID COORDINATE
	FINISHED GRADE ELEVATION
	EXISTING AC PAVEMENT
	NEW PCC SLAB - SEE NOTE 1
	NEW AC SLAB
	EXISTING EDGE OF PAVEMENT
	NEW EDGE OF PAVEMENT
	EXISTING SEWER LINE & DRAINAGE
	NEW STORM DRAIN
	EXISTING CONTOUR
	NEW CONTOUR

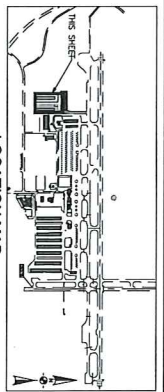

TRUCKEE TAHOE AIRPORT		CALIFORNIA		ENGINEER OF RECORD	
EXECUTIVE HANGAR DEVELOPMENT - PHASE 1				DRAFT	
SITE DEVELOPMENT					
GRADING PLAN					
DATE	DATE	BY	APR	DATE	
DRAWN	MSB				
CHECKED	RWB				
PROJECT NO.	40262				
THESE 2/25 GRADING PLAN					
SCALE	1"=20'				
SHEET NO.	5 of 11				

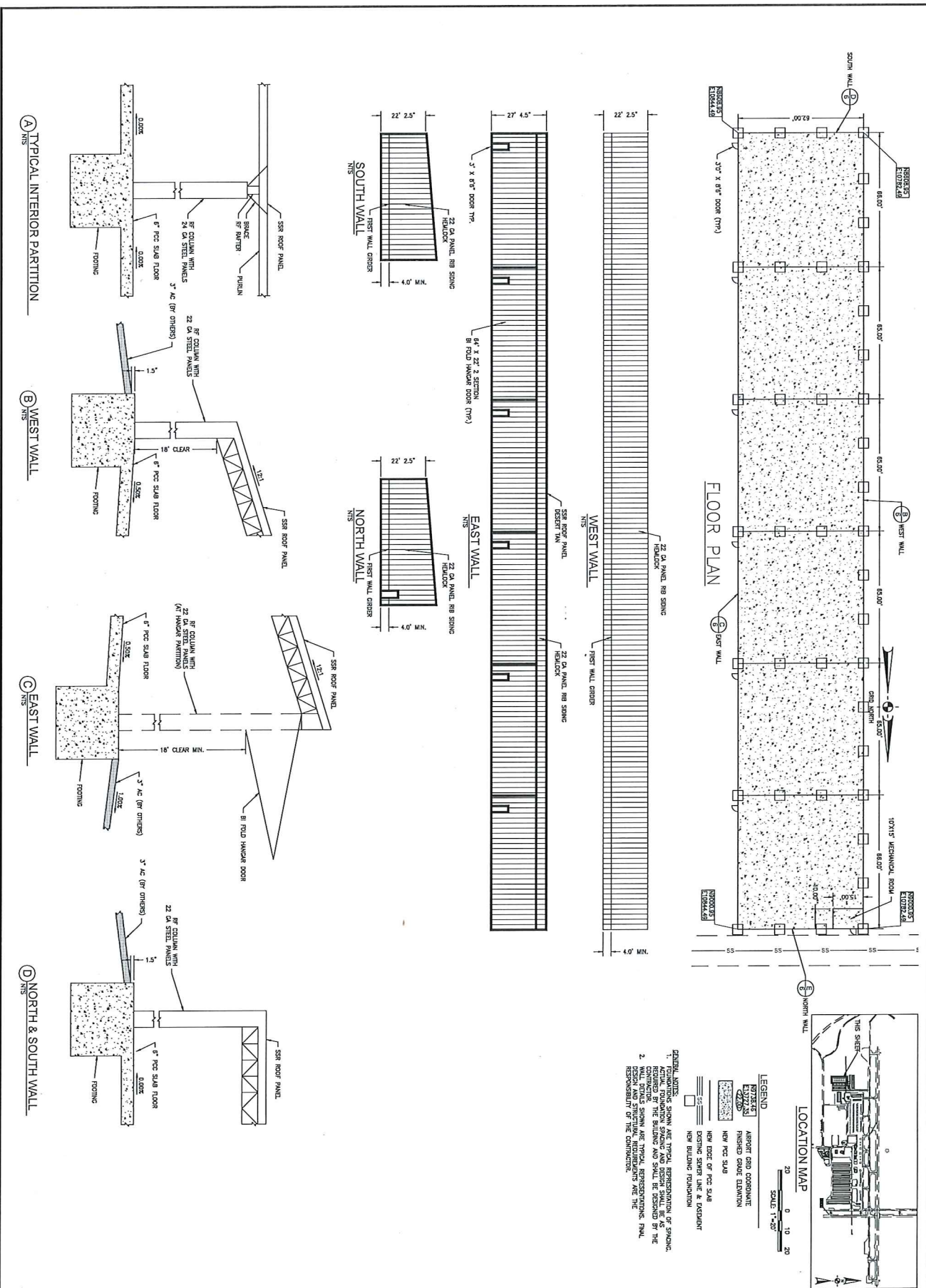

GENERAL NOTES:
 1. FOUNDATION SHOWS ARE TYPICAL REPRESENTATION OF SYMBOLS REQUIRED BY THE BUILDING AND SHALL BE DESIGNED BY THE ARCHITECT.
 2. WALL DETAILS SHOWN ARE TYPICAL REPRESENTATIONS. FINAL DESIGN AND STRUCTURAL REQUIREMENTS ARE THE RESPONSIBILITY OF THE CONTRACTOR.

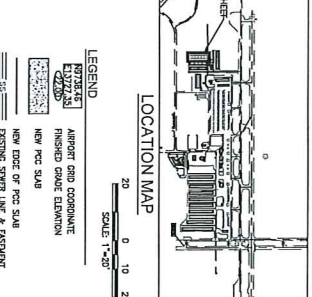

TRUCKEE TAHOE AIRPORT EXECUTIVE HANGAR DEVELOPMENT - PHASE 1 HANGAR BUILDINGS BUILDING PLAN AND DETAILS		No. _____ REVISIONS _____ BY _____ DATE _____		ENGINEER OF RECORD _____ DATE _____	
TRUCKEE CALIFORNIA		No. _____ REVISIONS _____ BY _____ DATE _____		ENGINEER OF RECORD _____ DATE _____	
DATE _____ DRAWN _____ CHECKED _____ PROJECT NO. 40241 SCALE 1/8" = 1'-0" SHEET NO. 6 of XX	REINARD W. BRANTLEY CONSULTING AIRPORT ENGINEER 6125 King Road, Suite 201 • Loomis, California 95650 • (916) 632-4725				