



Parks  
Make  
Life  
Better!

# NORTH TAHOE PUBLIC UTILITY DISTRICT

PROJECT UPDATE

Multi-Use Trailhead Improvements in the North Tahoe Regional Park

A presentation for the Truckee Tahoe Airport District  
May 22, 2019

# North Tahoe Public Utility District

Sewer collection, water and parks service provider serving approximately 5500 sewer/parks customers and 3800 water customers along 8.3 miles of shoreline from the California state line in Crystal Bay to Dollar Hill

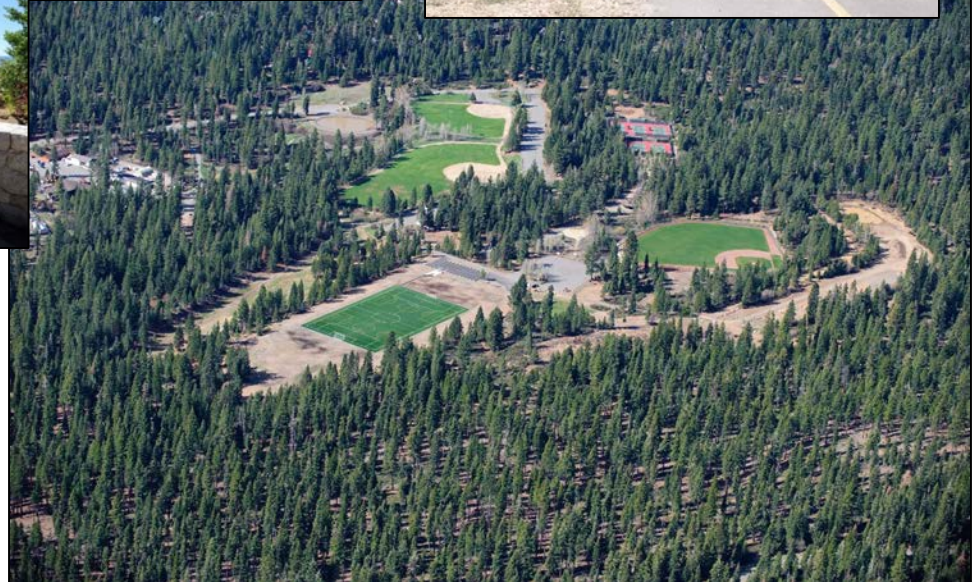

# Regional Trail System

Placer County has started environmental studies and permitting for the North Tahoe Shared Use Trail now that the 2.2 mile Dollar Creek Shared Use Trail is nearly completed.

Trail Corridor Identified in Regional Planning Efforts:

- TRPA Regional Goals and Policies 1987
- Air Quality Plan 1999 & 2003
- Environmental Improvement Program 2001
- Regional Transportation Plan: TRPA/TMPO 2008
- Lake Tahoe Regional Bicycle and Pedestrian Plan 2010
- Placer County Parks and Trails Master Plan 2018

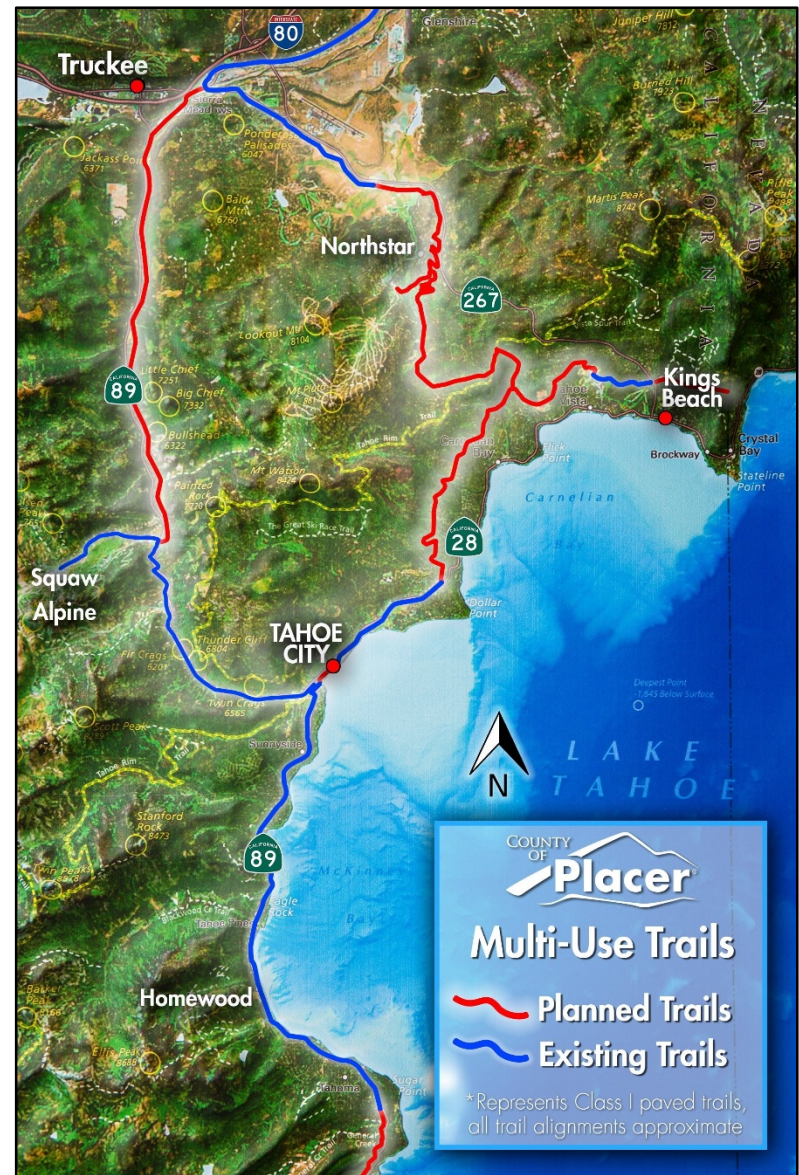

# North Tahoe Regional Park Regional Trailhead Improvements

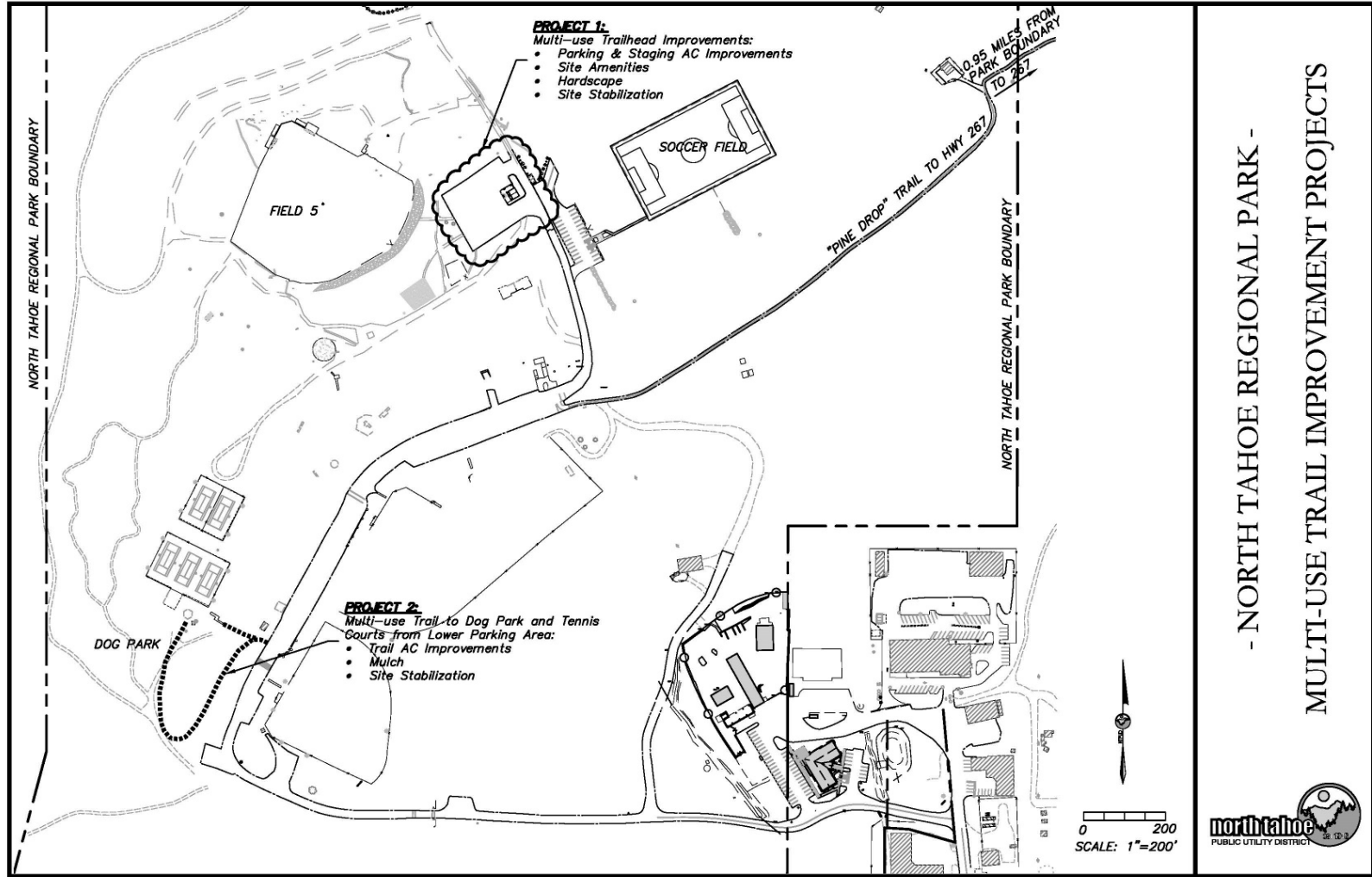

- NORTH TAHOE REGIONAL PARK -  
MULTI-USE TRAIL IMPROVEMENT PROJECTS

# Multi-Use Trailhead Improvements

## Current Project Costs

Construction Contract: \$440,000

Construction Contingency (10%): \$44,000

Executed Change Orders To Date: \$17,000

NTPUD Installed Site Amenities: \$22,000

Bike Racks: \$10,000

Bike Wash and Repair Station: \$9,000

Signage: \$3,000

Engineering/Design: \$15,000

Current Project Total (estimated): \$521,000

# Partnership to Support Multi-Use Trailhead Improvements



**\$320,000 Partnership between Truckee Tahoe Airport District & North Tahoe Public Utility District**

**\$160,000/ year in 2018 and 2019**

**NTPUD: In-kind Engineering, Project Management, and Site Amenity Installation Labor**



# Partnership to Support Multi-Use Trailhead Improvements

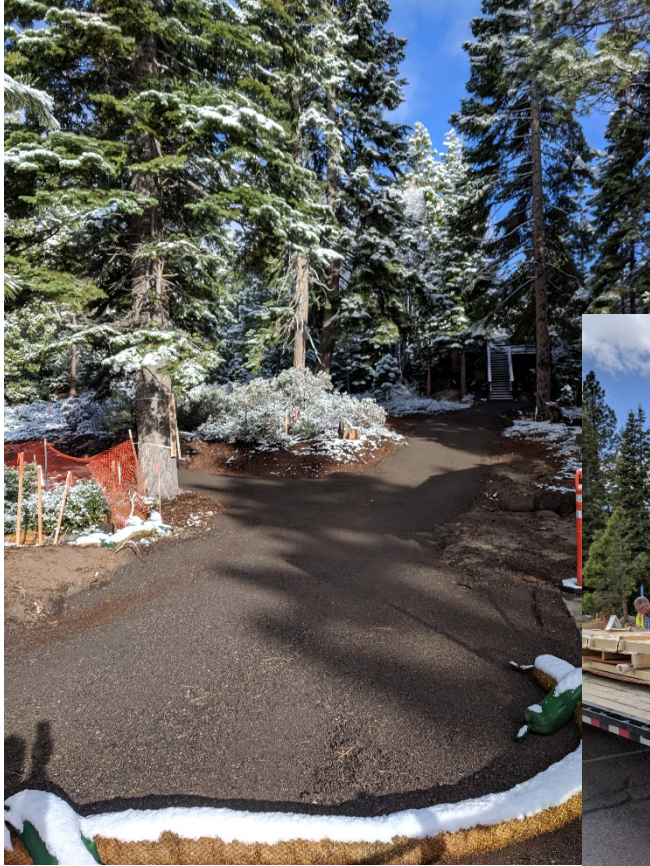

# Multi-Use Trailhead Improvements

## Current Project Funding Support

Truckee Tahoe Airport District: \$320,000

Additional Partnership Funding following TTAD Commitment

Placer County Park Dedication Fees: \$200,000

California Office of Emergency Services FEMA Grant: \$35,500

Placer County 2018 CAP Funding (repair station purchase): \$2,000

Total Project Support: \$557,500







**TRUCKEE  
TAHOE  
AIRPORT**  
Community Partner

**Parks  
Make  
Life  
Better!**



**Thank you for your partnership.**

