

Proposed Grass Runways  
 \* LAND USE ONLY

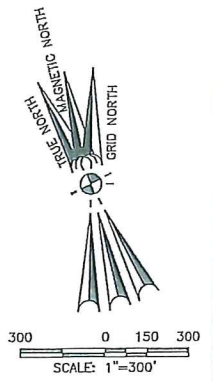

Reinard W. Brandley  
 CONSULTING AIRPORT ENGINEER  
 6125 King Road, Suite 201 • Leamie, California 95650 • (916) 652-4725

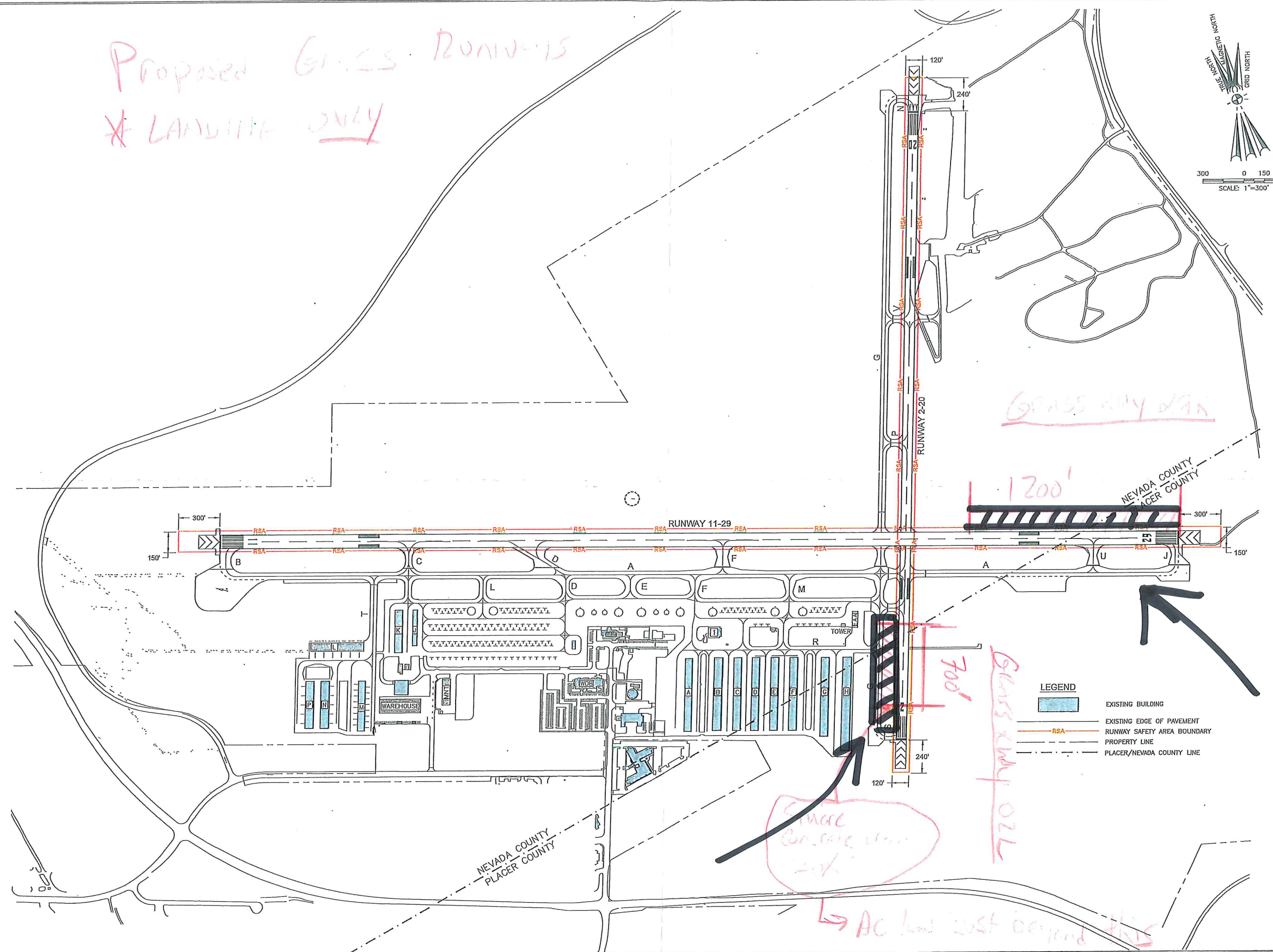

Grass Runway 02R

700'  
 Grass Runway 02L

Grass Runway 02L

AC has just beyond this

- LEGEND**
- EXISTING BUILDING
  - EXISTING EDGE OF PAVEMENT
  - RUNWAY SAFETY AREA BOUNDARY
  - PROPERTY LINE
  - PLACER/NEVADA COUNTY LINE

TRUCKEE TAHOE AIRPORT		CALIFORNIA	
AIRPORT LAYOUT		OVERALL AIRPORT LAYOUT	
DATE	MARCH 12, 2019	BY	DATE
DRAWN	DMB	REVISIONS	ENGINEER OF RECORD
CHECKED	DB	No.	
PROJECT No.			
FILE	TRK Layout 2019		
SCALE	1"=300'		
SHEET No.	1 of 1		