

GENERAL NOTES

CONTRACTOR RESPONSIBILITIES:
UNLESS EXPLICITLY STATED IN THESE CONSTRUCTION DOCUMENTS, BY NOTE OR CLARIFICATION LETTER, THE ENTIRE SCOPE OF WORK REPRESENTED BY THESE DOCUMENTS SHALL BE THE SOLE RESPONSIBILITY OF THE GENERAL CONTRACTOR.

THESE CONSTRUCTION DOCUMENTS REPRESENT THE DESIGN INTENT OF THE DESIGN TEAM BASED ON DIMENSIONS OF EXISTING SITE AND/OR FIELD CONDITIONS. ACTUAL CONDITIONS MAY REQUIRE MODIFICATIONS OF THE CONSTRUCTION DETAILS TO ACHIEVE THE DESIGN INTENT. CONTRACTOR SHALL NOTIFY DESIGN TEAM IN WRITING OF ANY DISCREPANCIES RELATED TO EXISTING SITE AND/OR FIELD CONDITIONS PRIOR TO CONTINUING ANY WORK.

IT IS THE RESPONSIBILITY OF THE CONTRACTOR TO RECORD ALL OMISSIONS OR CONFLICTS BETWEEN THE VARIOUS ELEMENTS OF THE CONSTRUCTION DOCUMENTS AND TO BRING THEM TO THE ATTENTION OF THE DESIGN TEAM PRIOR TO COMMENCING ANY WORK. ANY DEVIATION FROM THE CONDITIONS SHOWN IN THESE CONSTRUCTION DOCUMENTS SHALL REQUIRE WRITTEN APPROVAL FROM THE DESIGN TEAM.

DO NOT SCALE THE DRAWINGS. WRITTEN DIMENSIONS SHALL TAKE PRECEDENCE OVER SCALED DIMENSIONS. ANY DISCREPANCIES BETWEEN THE DRAWINGS AND ACTUAL CONDITIONS SHALL BE BROUGHT TO THE ATTENTION OF THE DESIGN TEAM PRIOR TO COMMENCING ANY WORK.

THE CONTRACT DOCUMENTS ARE COMPLEMENTARY. WORK REQUIRED TO BE DONE BY ONE DOCUMENT AND NOT BY OTHERS SHALL BE DONE AS IF REQUIRED BY ALL.

THE CONTRACTOR AND SUBCONTRACTOR SHALL MAKE NO STRUCTURAL SUBSTITUTIONS, CHANGES, OR MODIFICATIONS WITHOUT WRITTEN APPROVAL OF THE STRUCTURAL ENGINEER.

CONTRACTORS AND SUBCONTRACTORS SHALL ENSURE THAT ALL WORK IS PERFORMED IN A PROFESSIONAL AND WORKMANLIKE MANNER BY SKILLED MECHANICS OF THE TRADE. SUBCONTRACTORS AND SUPPLIERS ARE HEREBY NOTIFIED THAT THEY ARE TO CONFER AND COOPERATE FULLY WITH EACH OTHER DURING THE COURSE OF CONSTRUCTION TO DETERMINE THE EXACT EXTENT AND OVERLAP OF EACH OTHER'S WORK AND TO SUCCESSFULLY COMPLETE THE EXECUTION OF THE WORK IN A TIMELY MANNER.

UNLESS SPECIFICALLY SHOWN OR NOTED ON THE DRAWINGS, NO STRUCTURAL MEMBER SHALL BE CUT, NOTCHED, BORED, OR OTHERWISE WEAKENED WITHOUT THE PERMISSION OF THE STRUCTURAL ENGINEER.

BUILDER'S SET: THIS SET OF DRAWINGS HAS BEEN PREPARED SUFFICIENT TO OBTAIN A BUILDING PERMIT. ALL MATERIALS AND METHODS OF CONSTRUCTION NECESSARY TO COMPLETE THE PROJECT ARE NOT NECESSARILY DESCRIBED IN THIS "BUILDER'S SET". THE IMPLEMENTATION OF THE DRAWINGS REQUIRES THE CONTRACTOR OR BUILDER TO BE THOROUGHLY KNOWLEDGEABLE WITH THE APPLICATIONS OF CODES AND THE METHODS OF CONSTRUCTION SPECIFIC TO THIS PROJECT AND TYPE OF CONSTRUCTION.

ALL WATERPROOFING, FLASHING, AND DRAINAGE ARE TO BE DESIGNED AND PROVIDED BY THE BUILDER.

COORDINATION BETWEEN DISCIPLINES
ANY DISCREPANCIES FOUND AMONG THE DRAWINGS, THESE GENERAL NOTES, AND THE SITE CONDITIONS SHALL BE REPORTED TO THE ENGINEER, WHO SHALL CORRECT SUCH DISCREPANCY IN WRITING. ANY WORK DONE BY THE GENERAL CONTRACTOR AFTER DISCOVERY OF SUCH DISCREPANCY SHALL BE DONE AT THE GENERAL CONTRACTOR'S RISK. THE GENERAL CONTRACTOR SHALL VERIFY AND COORDINATE DIMENSIONS AMONG ALL DRAWINGS PRIOR TO PROCEEDING WITH ANY WORK OR FABRICATION. THE STRUCTURE HAS BEEN DESIGNED TO RESIST CODE REQUIRED VERTICAL AND LATERAL FORCES AFTER THE CONSTRUCTION OF ALL STRUCTURAL ELEMENTS HAS BEEN COMPLETED. STABILITY OF THE STRUCTURE PRIOR TO COMPLETION IS THE SOLE RESPONSIBILITY OF THE GENERAL CONTRACTOR. THIS RESPONSIBILITY INCLUDES BUT IS NOT LIMITED TO JOB SITE SAFETY, ERECTION MEANS, METHODS, AND SEQUENCES; TEMPORARY SHORING, FORMWORK, AND BRACING; USE OF EQUIPMENT AND CONSTRUCTION PROCEDURES. PROVIDE ADEQUATE RESISTANCE TO LOADS ON THE STRUCTURES DURING CONSTRUCTION PER SEI/ASCE STANDARD NO. 37 "DESIGN LOADS ON STRUCTURES DURING CONSTRUCTION". CONSTRUCTION OBSERVATION BY THE STRUCTURAL ENGINEER IS FOR GENERAL CONFORMANCE WITH DESIGN ASPECTS ONLY AND IS NOT INTENDED IN ANY WAY TO REVIEW THE CONTRACTOR'S CONSTRUCTION PROCEDURES.

STANDARDS
ALL METHODS, MATERIALS, AND WORKMANSHIP SHALL CONFORM TO THE 2022 CALIFORNIA BUILDING CODE (CBC) AS AMENDED AND ADOPTED BY THE LOCAL BUILDING OFFICIAL OR APPLICABLE JURISDICTION.

IN-KIND DEFINITION:

A REPLACEMENT THAT SATISFIES THE DESIGN SPECIFICATION.

REPLACEMENT OF BUILDING COMPONENTS USING THE SAME MATERIAL AND SIZES AS ORIGINALLY CONSTRUCTED.

STRUCTURAL STEEL

DETAILING, FABRICATION AND ERECTION

ALL WORKMANSHIP SHALL CONFORM TO THE CURRENT AISC MANUAL OF STEEL CONSTRUCTION AND AISC 360 CURRENT EDITION.

STEEL MEMBERS ARE EQUALLY SPACED BETWEEN DIMENSION POINTS UNLESS NOTED OTHERWISE.

ALL FABRICATION SHALL BE PERFORMED BY A FABRICATOR CERTIFIED BY THE AMERICAN INSTITUTE OF STEEL CONSTRUCTION.

THE CONTRACTOR SHALL BE RESPONSIBLE FOR ALL ERECTION AIDS AND JOINT PREPARATIONS THAT INCLUDE BUT ARE NOT LIMITED TO, ERECTION ANGLES, LIFT HOLES, AND OTHER AIDS, WELDING PROCEDURES, REQUIRED ROOT OPENINGS, ROOT FACE DIMENSIONS, GROOVE ANGLES, BACKING BARS, WELD EXTENSION TABS, COPIES, SURFACE ROUGHNESS VALUES AND TAPERS OF UNEQUAL PARTS. THE CONTRACTOR SHALL BE RESPONSIBLE FOR THE COMPLIANCE WITH ALL CURRENT OSHA REQUIREMENTS.

HOLES, COPIES, OR OTHER CUTS OR MODIFICATIONS OF THE STRUCTURAL STEEL MEMBERS SHALL NOT BE MADE IN THE FIELD WITHOUT WRITTEN APPROVAL FROM THE STRUCTURAL ENGINEER.

ALL STRUCTURAL STEEL SURFACES SHALL BE SHOP PAINTED. ALL STEEL EXPOSED TO WEATHER SHALL HAVE TWO COATS OF PAINT. ALL EXPOSED STRUCTURAL STEEL SHALL SATISFY AISC REQUIREMENTS FOR ARCHITECTURALLY EXPOSED STRUCTURAL STEEL (AESS) UNLESS WAIVED IN WRITING BY ARCHITECT.

MATERIAL PROPERTIES

WIDE FLANGE SECTIONS: ASTM A992 (F_y = 50 KSI)
OTHER SHAPES AND PLATES: ASTM A36 (F_y = 36 KSI)
STRUCTURAL STEEL PIPES: ASTM A53, GRADE B, TYPE E OR S (F_y = 35 KSI)
STEEL STRUCTURAL TUBING: ASTM A500, GRADE C, (F_y = 50 KSI)
MACHINE BOLTS (M.B.): ASTM A307, GRADE A
HIGH-STRENGTH BOLTS: A325-ASTM F1552, A490-ASTM A490
ANCHOR BOLTS (A.B.): ASTM F1554, GRADE 36, CLASS 2A

STUDS

STUDS SHALL BE AS SPECIFIED IN AWS D1.1 CLAUSE 7, WITH MATERIAL AS REQUIRED IN CLAUSE 7.2.6.
TYPE A (F_y = 49 ksi, F_t = 61 ksi) ARE ALLOWED FOR STEEL TO WOOD CONNECTIONS.
TYPE B (F_y = 51 ksi, F_t = 65 ksi) SHALL BE USED IN ALL OTHER CONNECTIONS AND ARE ACCEPTABLE FOR WOOD CONNECTIONS.

ALL STUDS SHALL BE DRAWN ARC WELDED

WELDING:

STRUCTURAL STEEL: WELD IN ACCORDANCE WITH "STRUCTURAL WELDING CODE" AWS D-1.1. 70 KSI MINIMUM WELD MATERIAL.

CERTIFICATION: ALL WELDING SHALL BE PERFORMED BY AWS CERTIFIED WELDERS. WELDERS SHALL BE PREQUALIFIED FOR EACH POSITION AND WELD TYPE WHICH THE WELDER WILL BE PERFORMING. IF WELDERS ARE NOT CERTIFIED, CONTRACTOR SHALL PAY FOR ANY INSPECTIONS BY TESTING AGENCY THAT WOULD NOT HAVE BEEN REQUIRED IF SHOP WAS CERTIFIED. WITHOUT CERTIFICATION, ALL WELDS SHALL BE CONSIDERED FIELD WELDS.

WELD TABS (ALSO KNOWN AS WELD "EXTENSION" TABS OR "RUN OFF" TABS SHALL BE USED. AFTER THE WELD HAS BEEN COMPLETED THE WELD TABS SHALL BE REMOVED AND THE WELD END ROUNDED TO A SMOOTH CONTOUR. WELD "DAMS" OR "END DAMS" SHALL NOT BE USED.

THE PROCESS CONSUMABLES FOR ALL WELD FILLER METAL INCLUDING TACK WELDS, ROOT PASS, AND SUBSEQUENT PASSES DEPOSITED IN A JOINT SHALL BE COMPATIBLE.

ALL WELD FILLER METAL AND WELD PROCESS SHALL PROVIDE CHARPY V-NOTCH TOUGHNESS RATING PER LATEST EDITION OF AISC 341.

SHOP DRAWINGS

THE FOLLOWING SHOP DRAWINGS/SUBMITTALS SHALL BE PROVIDED FOR REVIEW AND APPROVAL BY THE STRUCTURAL ENGINEER PRIOR TO FABRICATION OR DELIVERY.

	STRUCTURAL ENGR.	BLDG. DEPT.
1. STRUCTURAL STEEL	X	

SPECIAL INSPECTION

STEEL SPECIAL INSPECTION SHALL CONFORM TO CURRENT CBC CODE. INSPECTION SHALL BE RESPONSIBILITY OF THE CONTRACTOR.

PLANS & DETAILS LEGEND

SHEET NUMBER DESCRIPTION

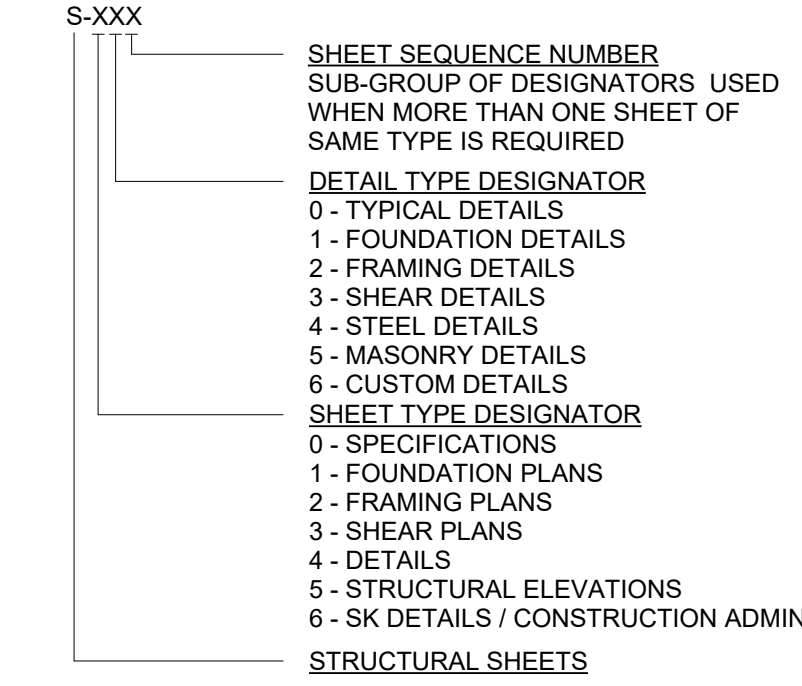

DETAIL CALL OUT DESCRIPTION

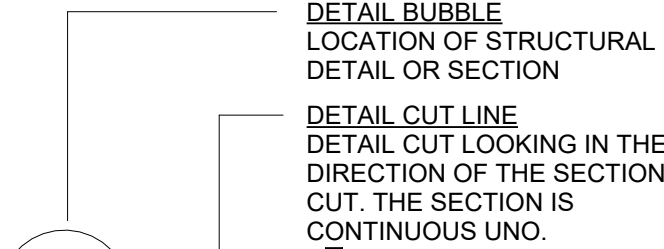

ABBREVIATIONS

- AB - ANCHOR BOLT
- ABV - ABOVE
- ADDL - ADDITIONAL
- ADJ - ADJACENT
- ARCH - ARCHITECTURAL
- AYC - ALASKAN YELLOW CEDAR
- BLKG - BLOCKING
- BLW - BELOW
- BN - BOUNDARY NAILS
- BOS - BOTTOM OF SHEATHING
- BTWN - BETWEEN
- CBC - CALIFORNIA BUILDING CODE
- CJ - CONSTRUCTION JOINT
- CL - CENTERLINE
- COL - COLUMN
- CONC - CONCRETE
- CONT - CONTINUOUS
- CVG - CONTINUOUS VERTICAL GRAIN
- DIAM - DIAMETER
- DF - DOUGLAS FIR
- DFPT - DOUGLAS FIR PRESSURE TREATED
- DL - DEAD LOAD
- DN - DOWN
- E - EXISTING
- EA - EACH
- EN - EDGE NAIL
- ENGR - ENGINEER
- ES - EACH SIDE
- EW - EACH WAY
- FDN - FOUNDATION
- FF - FINISH FLOOR
- FOS - FACE OF STUD
- FRMG - FRAMING
- FS - FAR SIDE
- GA - GAGE
- GALV - GALVANIZED
- GC - GENERAL CONTRACTOR
- GLB - GLUED LAMINATED BEAM
- GYP - GYPSUM BOARD
- HD - HOLDOWN
- HORIZ - HORIZONTAL
- HSS - HOLLOW STRUCTURAL SECTION
- IBC - INTERNATIONAL BUILDING CODE
- INTR - INTERMEDIATE
- INV - INVERTED
- K - KIPS
- KP - KING POST
- KS - KING STUD
- LL - LIVE LOAD
- LLV - LONG LEG VERTICAL
- LLH - LONG LEG HORIZONTAL
- LSL - LAMINATED STRAND LUMBER
- LVL - LAMINATED VENEER LUMBER
- LWT - LIGHTWEIGHT
- MAX - MAXIMUM
- MECH - MECHANICAL
- MFR - MANUFACTURER
- MIN - MINIMUM
- MISC - MISCELLANEOUS
- N - NEW
- NS - NEAR SIDE
- OC - ON CENTER
- OCEW - ON CENTER EACH WAY
- OF - OUTER FACE
- OH - OPPOSITE HAND
- OPNG - OPENING
- PARA - PARALLEL
- PERP - PERPENDICULAR
- PL - PLATE
- PLF - POUNDS PER LINEAR FOOT
- PSF - POUNDS PER SQUARE FOOT
- PSL - PARALLEL STRAND LUMBER
- PT - PRESSURE TREATED
- PW - PLYWOOD
- REINF - REINFORCEMENT
- REQ - REQUIRED
- SCHED - SCHEDULE
- SHTG - SHEATHING
- SIM - SIMILAR
- SMS - SHEET METAL SCREW
- SOG - SLAB ON GRADE
- STAG - STAGGERED
- STD HK - STANDARD HOOK
- STIFF - STIFFENER
- STL - STEEL
- SW - SHEARWALL
- SYM - SYMMETRICAL
- T&B - TOP & BOTTOM
- T&G - TONGUE AND GROOVED
- THRU - THROUGH
- TN - TOE NAIL
- TS - TUBE STEEL
- TYP - TYPICAL
- UNO - UNLESS NOTED OTHERWISE
- VERT - VERTICAL
- VIF - VERIFY IN FIELD
- w/ - WITH
- WWF - WELDED WIRE FABRIC

PROJECT SUMMARY

THE PROJECT IS THE REPAIR OF EXISTING AIRPLANE HANGERS THAT HAD SNOW DAMAGE.

DAMAGE WAS LESS THAN SUBSTANTIAL, SO DAMAGED ELEMENTS ARE REPLACED TO CURRENT CODE, BUT THE BUILDING WILL NOT BE UPGRADED. AFTER DAMAGE REPAIRED THE ROOF WILL BE REPLACE. THE ROOF REPLACEMENT HAS NO INCREASE IN LOADING DO DOES NOT TRIGGER UPGRADE.

SHEET INDEX

SHEET NUMBER	SHEET NAME
S-000	COVER PAGE
S-001	HANGER LAYOUT
S-100	WALL PANEL REPAIRS
S-200	RE-ROOF REPAIR HANGER A-F
S-201	HANGER H REPAIRS
S-800	ROOF FRAMING PLAN

APPLICABLE CODES

2022 CALIFORNIA BUILDING CODE	(2022 CBC)
2022 CALIFORNIA EXISTING BUILDING CODE	
2018 NATIONAL DESIGN STANDARD	(2018 NDS)
STEEL CONSTRUCTION MANUAL, 15 ED.	(AISC 15 ED.)

PROJECT INFORMATION

ERIN BROOMHALL / DOUG GADOW
LINCHPIN STRUCTURAL ENGINEERING
530.563.6341 EXT. 807 (ERIN)

(E) METAL BUILDING SNOW LOAD

CURRENT METAL BUILDING APPEARS TO HAVE BEEN DESIGNED FOR A GROUND SNOW LOAD OF 40 PSF / ROOF SNOW LOAD OF 28 PSF.

NOTE: BUILDING LOADING MAY NOT BE INCREASED BY MORE THAN 5% OR SHALL BE UPGRADE TO THE CURRENT BUILDING CODE AND GROUND DESIGN SNOW LOAD OF 180 PSF. THIS IS NOT TRIGGERED.

DESIGN CRITERIA

(FOR ADDITIONAL ZEE - PURLINS ONLY)

VERTICAL LOADS

AREA	DESIGN DEAD LOAD	LIVE LOAD	CONCENTRATED LOADS
ROOF	5 PSF	20 PSF	--

SNOW:

P_s = 180 PSF (GROUND SNOW LOAD)
P_f = .7P_sC_eC_i = 125 PSF (FLAT ROOF SNOW LOAD)
I_s = 1.0, C_e = 1.0, C_i = 1.1, C_s = 1.0



1001 West River Street, Truckee, CA 96161
530.563.6341
530 California Ave, Reno, NV 89509
775.857.3744
info@linchpinse.com
www.linchpinse.com

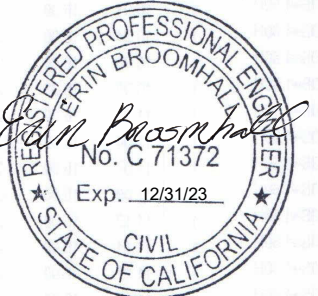

9/1/23

REVISIONS

These Drawings have been prepared by Linchpin Structural Engineering Inc. They are not suitable for use on other projects, in other locations, or by any other individuals without the written approval and participation of Linchpin Structural Engineering Inc. Reproduction is prohibited.

TRUCKEE AIRPORT HANGER REPAIRS

10356 Truckee Airport Rd
Truckee, CA 96161

DESIGNED BY EB
DRAFTED BY EB

CLIENT INFORMATION
GARLAND COMPANY, INC

PROJECT# 23-086

ISSUE DATE 9/1/23

SCALE 1" = 1'-0"

COVER PAGE

S-000

HANGER "K"

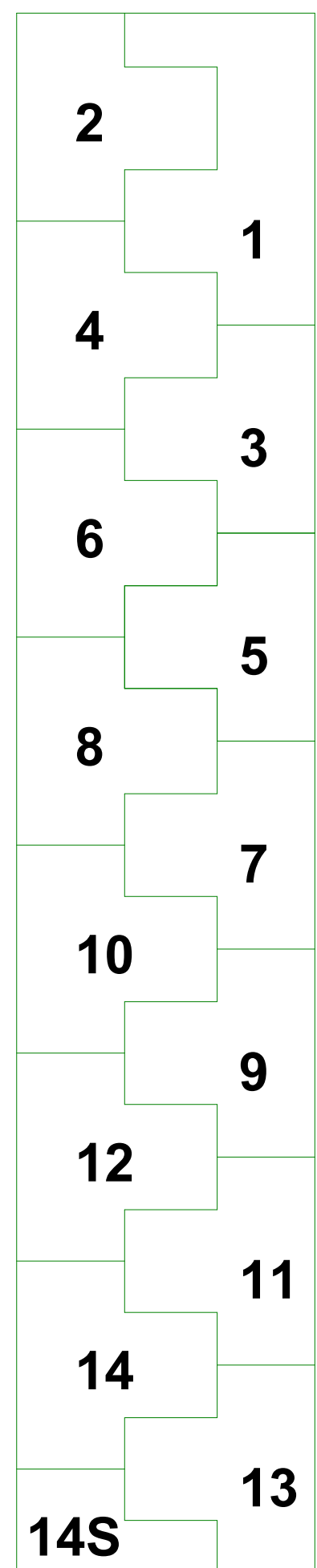

HANGER "J"

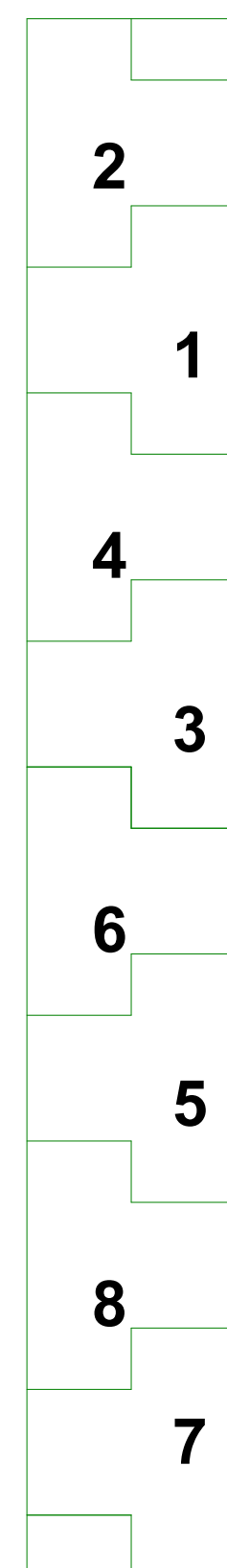

HANGERS K & J ARE LOCATED TO WEST OF AIRPORT BUILDING

HANGER "A"

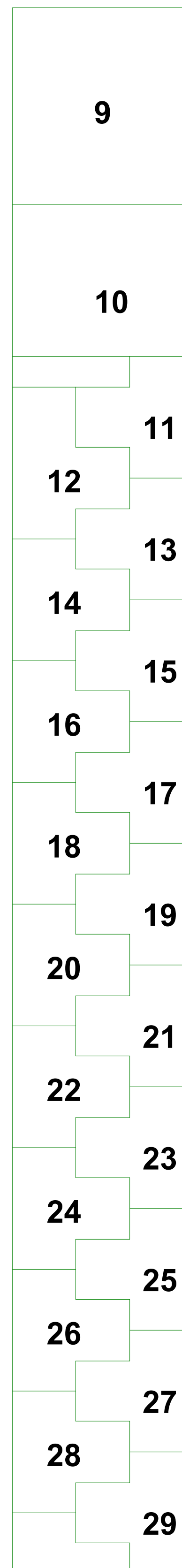

HANGER "B"

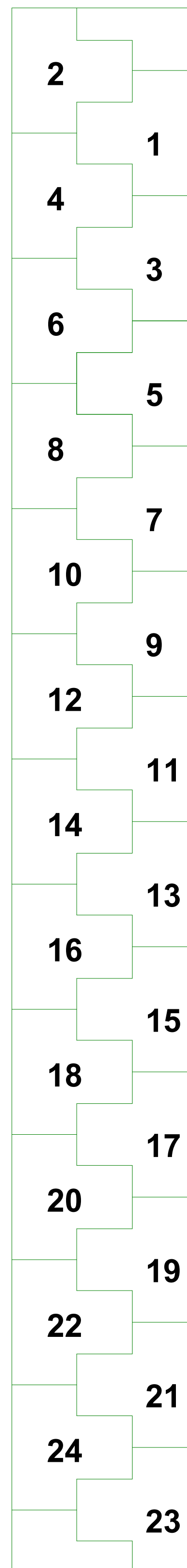

HANGER "C"

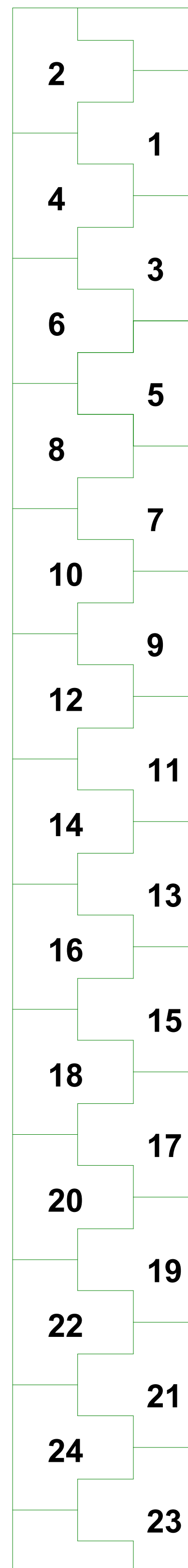

HANGER "D"

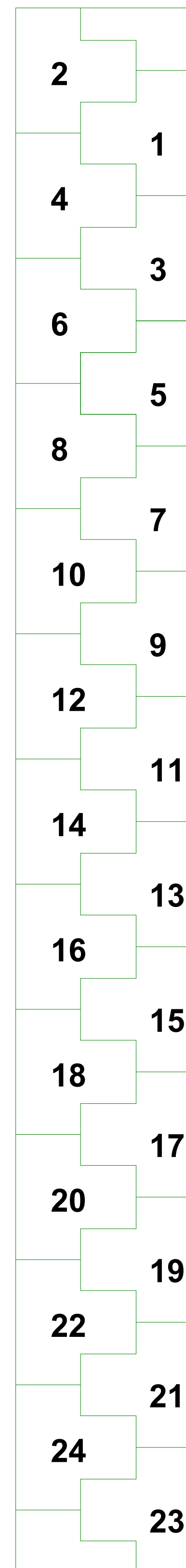

HANGER "E"

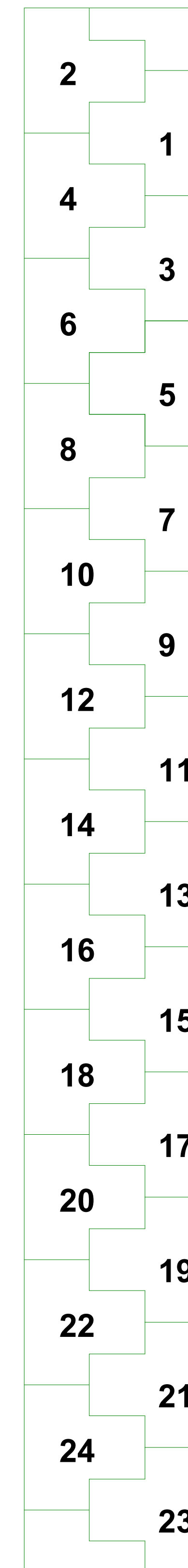

HANGER "F"

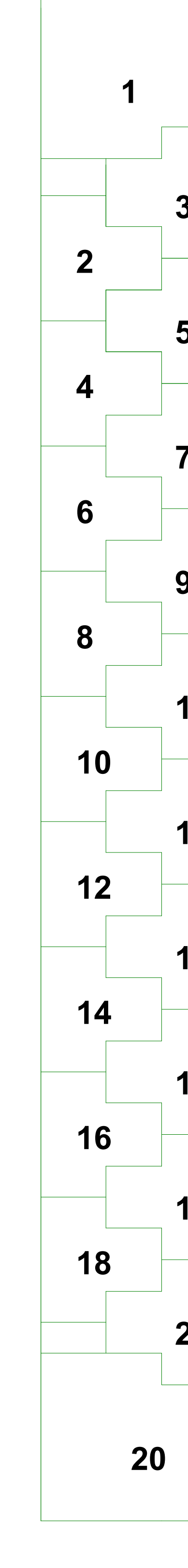

HANGER "G"

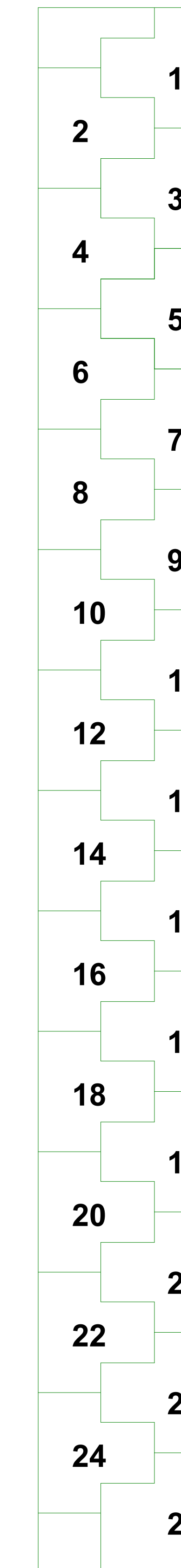

HANGER "H"

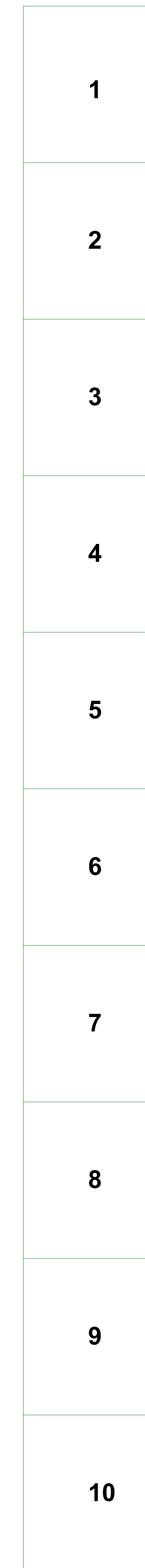

PRINT DATE: 9/1/2023 3:49:29 PM



9/1/23

REVISIONS

These Drawings have been prepared by Linchin Structural Engineering Inc. They are not suitable for use on other projects, in other locations, or by any other individuals without the written approval and participation of Linchin Structural Engineering Inc. Reproduction is prohibited.

TRUCKEE AIRPORT HANGER REPAIRS

10356 Truckee Airport Rd
Truckee, CA 96161

DESIGNED BY EB
DRAFTED BY EB

CLIENT INFORMATION
GARLAND COMPANY, INC

PROJECT# 23-086

ISSUE DATE 9/1/23

SCALE 1" = 30'-0"

HANGER LAYOUT

S-001

1 SITE PLAN / UNIT LAYOUT (FOR REFERENCE)
1" = 30'-0"

DAMAGED WALL PANEL REPLACEMENT BY OTHERS
(VIF, NO STRUCTURAL DAMAGE TO SUPPORT EAVE GIRDER (4" SQ TUBES) WHEN WALL PANEL REMOVED,
IF DAMAGED CONTACT STRUCTURAL ENGINEER)

PANELS AND STRUCTURAL SUPPORTS TO BE REPLACE IN-KIND,
AS REQUIRED.

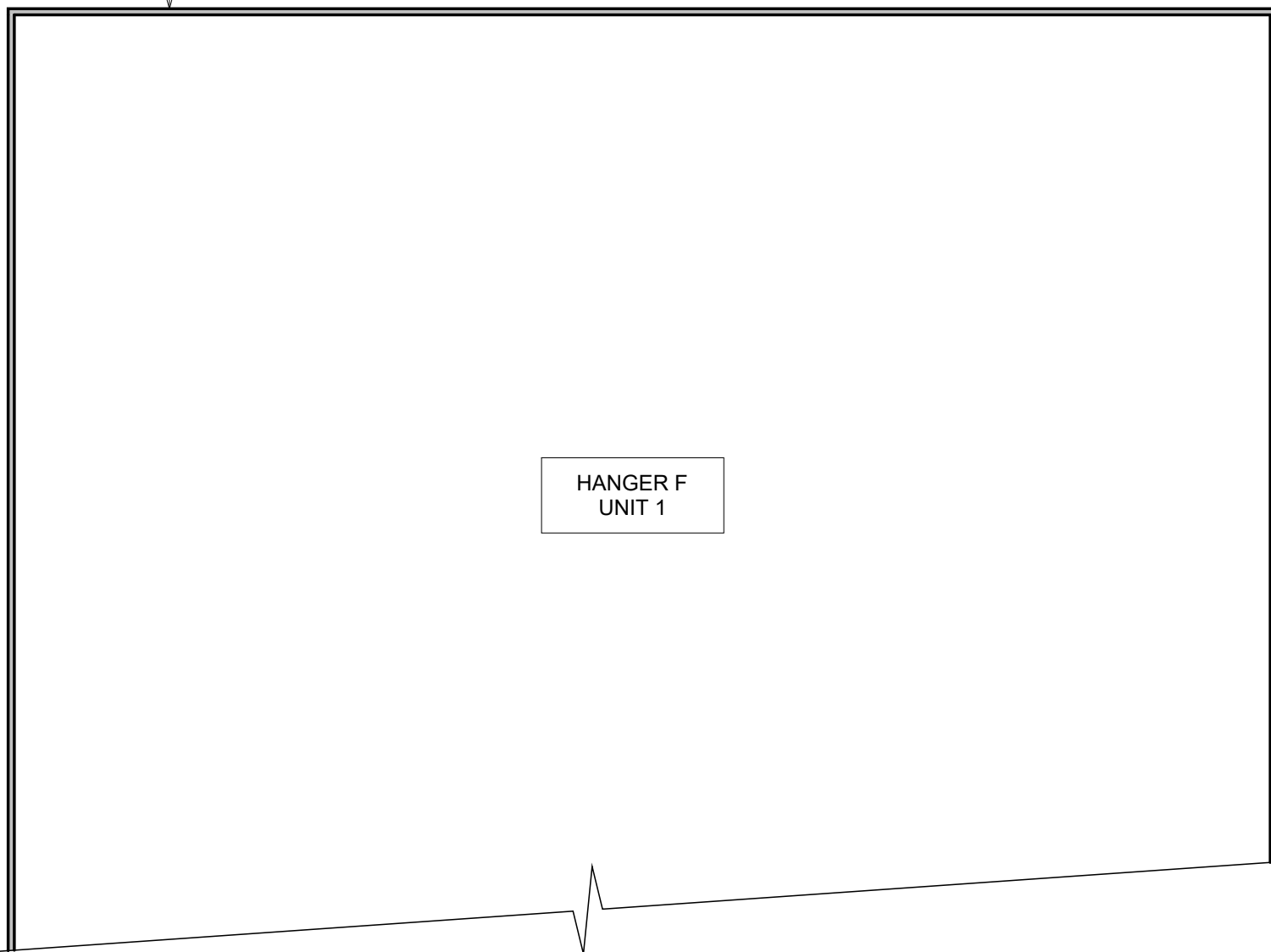

HANGER F
UNIT 1

DAMAGED WALL PANEL REPLACEMENT BY OTHERS.
WALL GIRDER SUPPORT TO BE REPLACED IN-KIND
CONTACT ENGINEER IF ADDITIONAL STRUCTURAL DAMAGE IS
OBSERVED TO EAVE GIRDER OR COLUMNS (4" SQ TUBES)
WHEN WALL PANEL REMOVED.

PANELS AND STRUCTURAL SUPPORTS TO BE REPLACE IN-KIND,
AS REQUIRED.

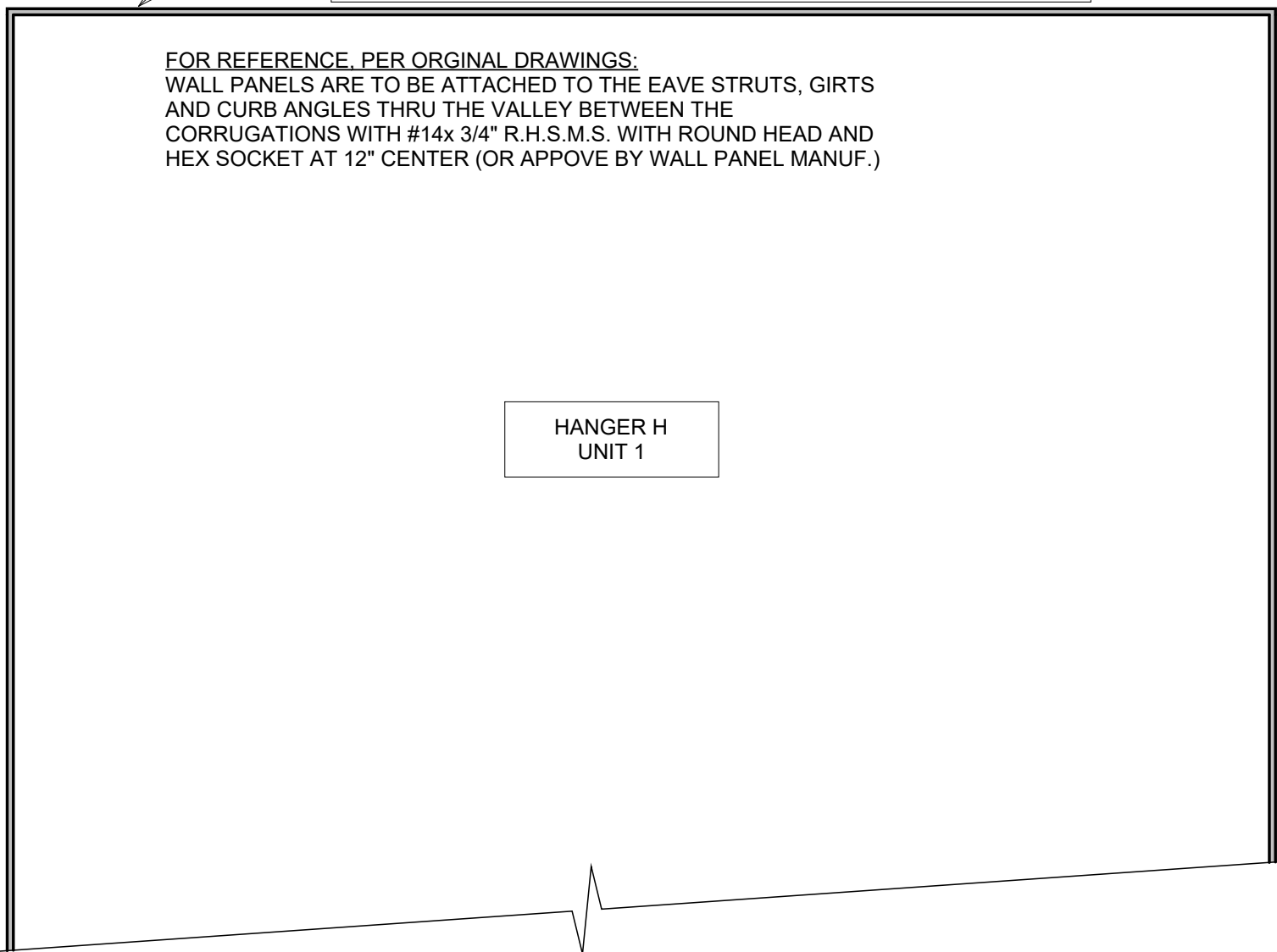

HANGER H
UNIT 1

FOR REFERENCE, PER ORIGINAL DRAWINGS:
WALL PANELS ARE TO BE ATTACHED TO THE EAVE STRUTS, GIRTS
AND CURB ANGLES THRU THE VALLEY BETWEEN THE
CORRUGATIONS WITH #14x 3/4" R.H.S.M.S. WITH ROUND HEAD AND
HEX SOCKET AT 12" CENTER (OR APPROVE BY WALL PANEL MANUF.)

INTERIOR WALL PANELS TO BE REPAIRED

HANGER A, UNIT 26: (3) PANELS
HANGER A, UNIT 28: (2) PANELS
HANGER C, UNIT C9: (1) WALL PANEL
HANGER C, UNIT C11: (1) WALL PANEL

CONTRACT ENGINEER IF WALL PURLIN OR TIE RODS ARE DAMAGED

WALL PANEL & STRUCTURAL SUPPORT REPAIRS
1/8" = 1'-0"

PRINT DATE: 9/1/2023 3:49:29 PM

LINCHPIN STRUCTURAL ENGINEERING

10356 Truckee Airport Rd, Truckee, CA 96161
530.564.6844
530 California Ave, Reno, NV 89509
775.857.3744
info@linchpinse.com
www.linchpinse.com

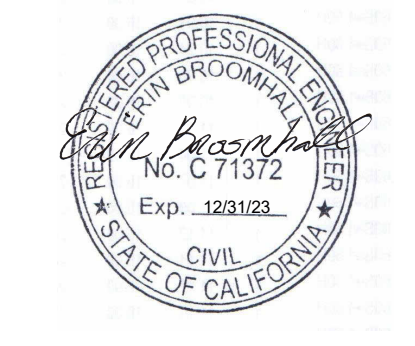

9/1/23

REVISIONS

These Drawings have been prepared by Linchpin Structural Engineering Inc. They are not suitable for use on other projects, in other locations, or by any other individuals without the written approval and participation of Linchpin Structural Engineering Inc. Reproduction is prohibited.

**TRUCKEE AIRPORT
HANGER REPAIRS**

10356 Truckee Airport Rd
Truckee, CA 96161

DESIGNED BY EB
DRAFTED BY EB

CLIENT INFORMATION
GARLAND COMPANY, INC

PROJECT# 23-086

ISSUE DATE 9/1/23

SCALE 1/8" = 1'-0"

WALL PANEL
REPAIRS

S-100

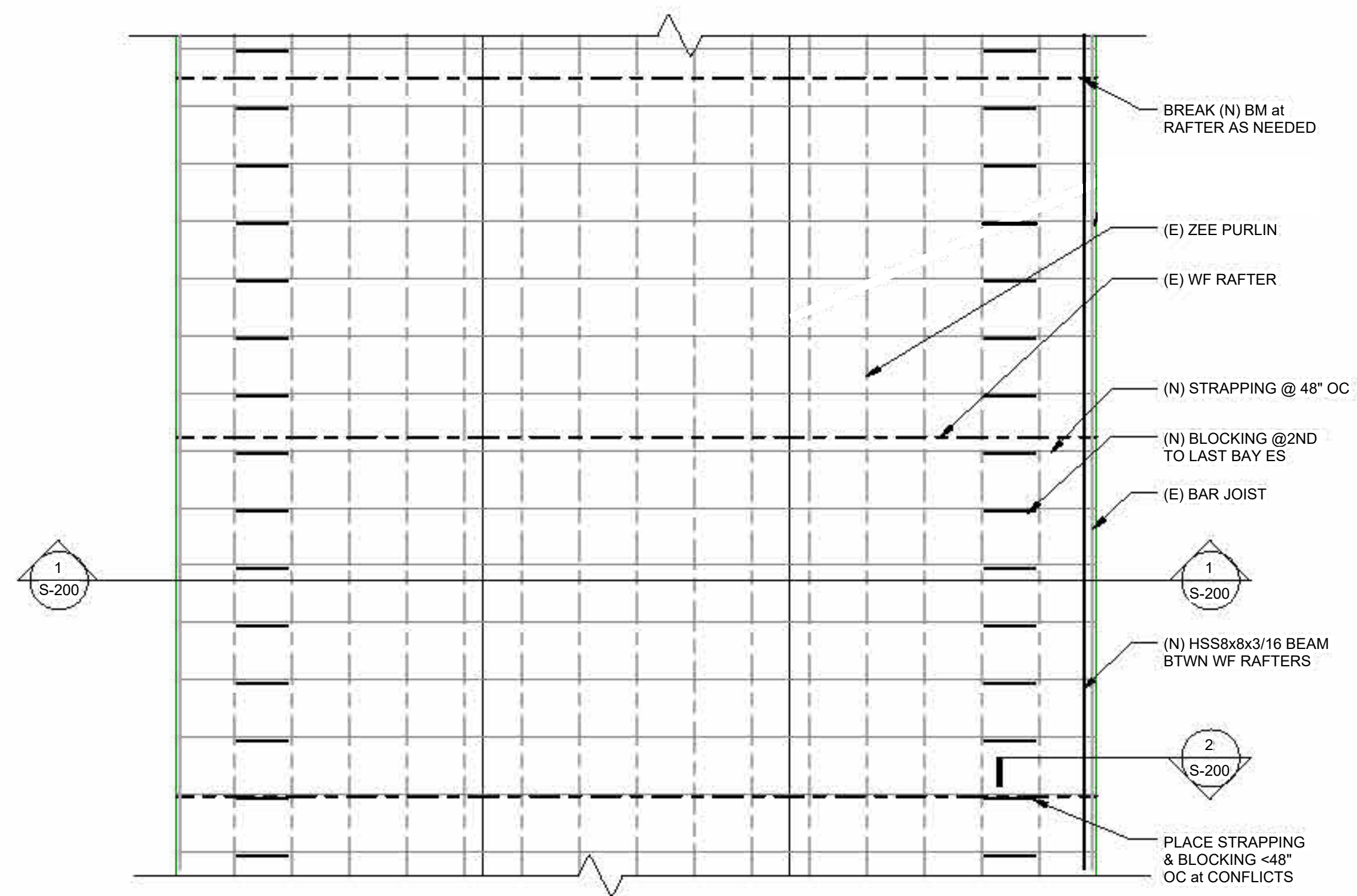

BRACING PLAN

ROOFING ATTACHMENT:
(SHOP DRAWINGS REQUIRED FOR APPROVAL)

- REPLACEMENT OF ROOF ZEE PURLIN ATTACHMENT:**
- ROOF ZEE-PURLIN TO RAFTER (WF): USE (2) 1/2" x 1-1/2" HEX HD (CONTACT ENGINEER IF ALTERNATIVE REQUESTED OR NOT WHAT IS CURRENTLY INSTALLED)
 - PER ZEE PURLIN TO ZEE PURLIN LAP: USE (4) 1/2" x 1-1/2" HEX HD
 - NOTE DO NOT REMOVE PARTITION ANGLE. USE SAME PURLIN BOLTS TO RAFTER (WF) IF REQUIRED.

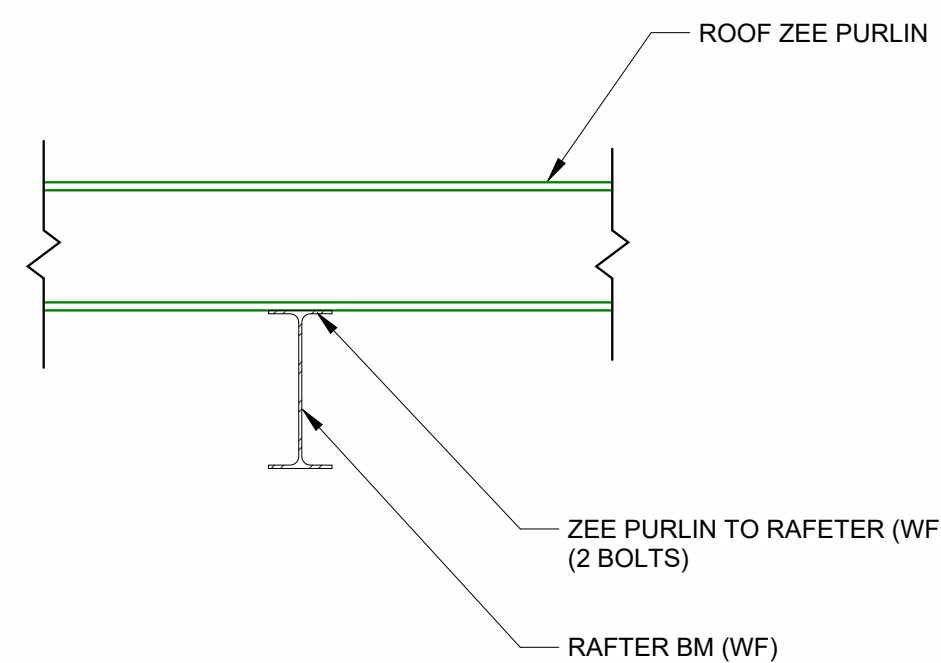

3 ZEE PURLING TO RAFTER BM
1/2" = 1'-0"

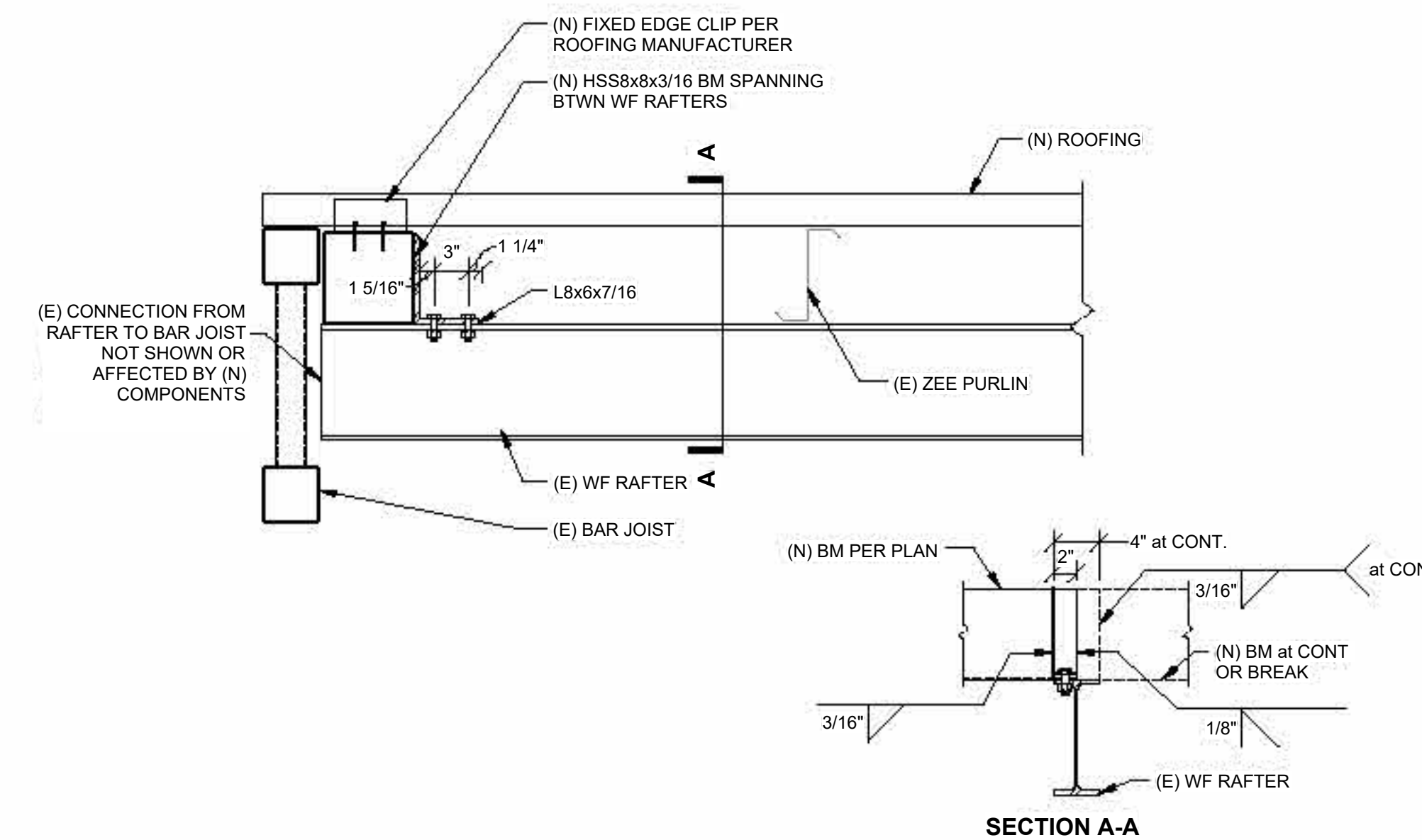

2 (N) BM TO RAFTERS
1" = 1'-0"

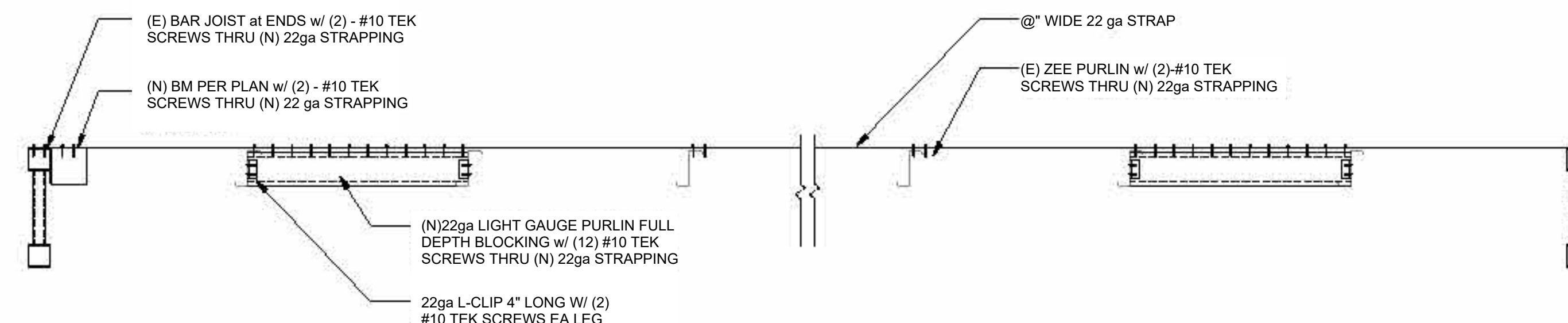

1 BRACING DETAIL
1/2" = 1'-0"

HANGER A-F "GENERAL" NOTES:

- STRUCTURAL REPAIRS REQUIRED. NOTE ADDITIONAL LOCATIONS MAY OCCUR.
- IF MORE THAN 2 ADJACENT ZEE PURLINS ARE DAMAGED, DECREASE THE SPACING TO 16" OC BY ADDING ADDITIONAL 8" ZEE PURLIN (14 GAGE) 3-1/2" FLANGES BETWEEN THE REPLACED PURLINS.
- BRACING PLAN (BELOW) REQUIRED FOR ALL UNITS.
- REPLACE (E) DAMAGED ROOF PANEL W/ FREE-FLOATING STANDING SEAM PANELS (SHOP DRAWINGS REQUIRED FOR APPROVAL)

HANGER A:

- UNITS 24-29 HAVE SIGNIFICANTLY MORE DAMAGED ZEE PURLINS DUE TO LIMITED EXPOSURE OF THESE UNITS, TREES FROM ADJACENT PROPERTY LIMITING MELT OF ROOFS. THUS, REPLACE ALL PURLINS W/ 8" ZEE PURLIN (14 GAGE) 3-1/2" FLANGES AT 16" OC.
- UNIT 17: REPLACE (1) DAMAGED ROOF ZEE PURLIN
- UNIT 24: (4) DAMAGED ROOF ZEE PURLINS, SEE NOTE ABOVE
- UNIT 28: (10) DAMAGED ROOF ZEE PURLINS, SEE NOTE ABOVE
- UNIT 27: (9) DAMAGED ROOF ZEE PURLIN, SEE NOTE ABOVE
- * FOR WALL DAMAGE AT UNITS A26 & 28, SEE SHEET S-100

HANGER B:

- IN UNIT 23: ROOF PANEL DAMAGED TO BE REPLACED

HANGER C:

- UNIT 7, REPLACE (1) DAMAGED ROOF ZEE PURLIN
- UNIT 9 & 11: SEE WALL PANEL (SHEET S-100)
- UNIT 21: REPLACE (1) DAMAGED ROOF ZEE PURLIN
- UNIT 24: REPLACE (1) DAMAGED ROOF ZEE PURLIN

HANGER D:

- UNIT 23: REPLACE (2) DAMAGED ROOF ZEE PURLINS

HANGER E:

- UNIT 13: REPLACE (2) DAMAGED ROOF ZEE PURLINS

HANGER F:

- NO REPAIRS NOTED, U.N.O.

HANGER G:

- NO REPAIRS NOTED, U.N.O.

HANGER H:

- SEE SHEET S-201: FOR DAMAGE & REPAIRS REQUIRED.

HANGER J*:

- UNIT 1: REPLACE (1) DAMAGED ROOF ZEE PURLIN
- UNIT 3: REPLACE (4) DAMAGED ROOF ZEE PURLINS
- UNIT 5: REPLACE (3) DAMAGED ROOF ZEE PURLINS

HANGER K*:

- UNIT 1: REPLACE (1) DAMAGED ROOF ZEE PURLIN
- UNIT 3: REPLACE (4) DAMAGED ROOF ZEE PURLINS
- UNIT 5: REPLACE (3) DAMAGED ROOF ZEE PURLINS
- UNIT 9: CONTRACTOR TO INSPECT UNIT, UNIT WAS UNABLE TO BE INSPECTED DURING LINCHPIN INSPECTION.
- UNIT 7: REPLACE (2) DAMAGED ROOF ZEE PURLINS
- UNIT 11: REPLACE (2) DAMAGED ROOF ZEE PURLINS
- UNIT 13: REPLACE (1) DAMAGED ROOF ZEE PURLIN

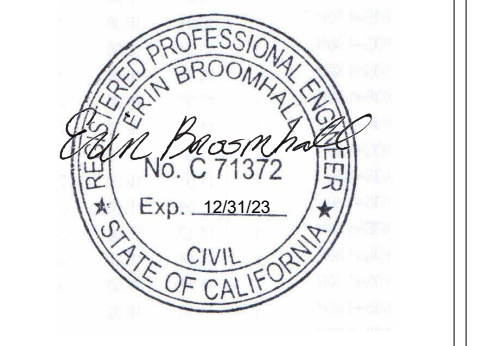

9/1/23

REVISIONS

These Drawings have been prepared by Linchpin Structural Engineering Inc. They are not suitable for use on other projects, in other locations, or by any other individuals without the written approval and participation of Linchpin Structural Engineering Inc. Reproduction is prohibited.

TRUCKEE AIRPORT HANGER REPAIRS

10356 Truckee Airport Rd
Truckee, CA 96161

DESIGNED BY EB
DRAFTED BY EB

CLIENT INFORMATION
GARLAND COMPANY, INC

PROJECT# 23-086

ISSUE DATE 9/1/23

SCALE 1" = 1'-0"

RE-ROOF REPAIR HANGER A-F

S-200

PRINT DATE: 9/1/2023 3:49:30 PM

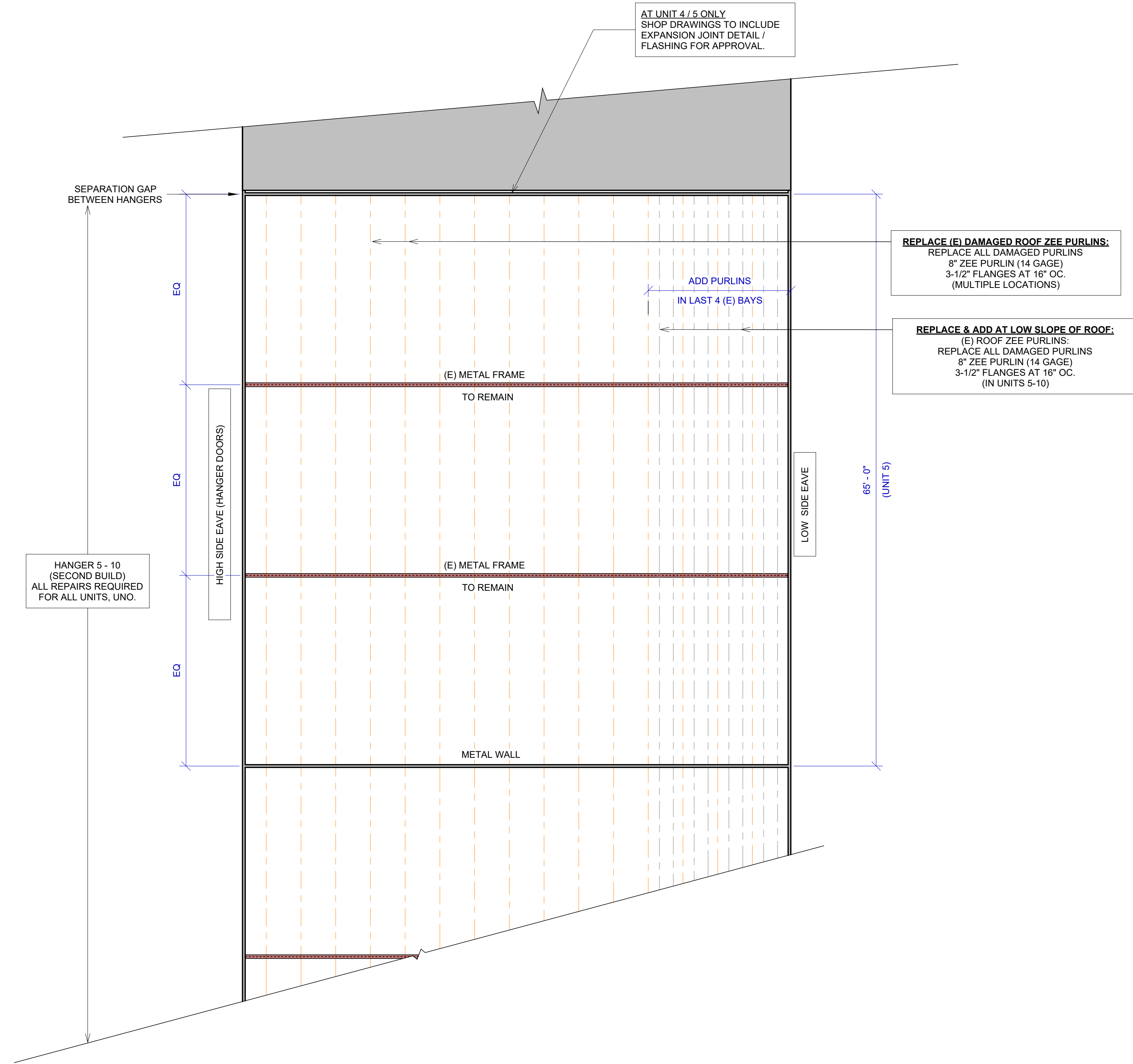

10356 Truckee Airport Rd, Truckee, CA 96161
 530.564.6844
 530 California Ave, Reno, NV 89509
 775.857.3744
 info@linchpinse.com
 www.linchpinse.com

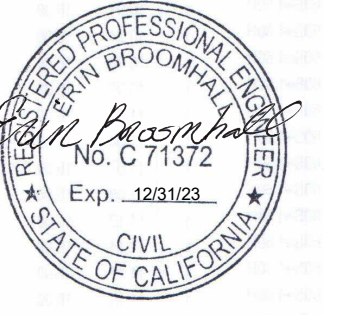

9/1/23

REVISIONS

These Drawings have been prepared by Linchpin Structural Engineering Inc. They are not suitable for use on other projects, in other locations, or by any other individuals without the written approval and participation of Linchpin Structural Engineering Inc. Reproduction is prohibited.

TRUCKEE AIRPORT HANGER REPAIRS

10356 Truckee Airport Rd
Truckee, CA 96161

DESIGNED BY EB
 DRAFTED BY EB

CLIENT INFORMATION
 GARLAND COMPANY, INC

PROJECT# 23-086

ISSUE DATE 9/1/23

SCALE 1/8" = 1'-0"

HANGER H
REPAIRS

S-201